

CATALOG

HORIUCHI MIRROR INDUSTRY CO., LTD.



Contents

■ Corporate Profile	1
■ What is “Napure Mirror”?	2
■ Manufacturing Facilities and Processes for “Napure Mirror”	3
■ “Napure Mirror” PROFESSIONAL MODEL FOLDABLE STAND MIRROR	4,5,6,7
■ “Napure Mirror” MAGNIFICATION MIRROR	8,9
■ “Napure Mirror” COMPACT MIRROR	10,11
■ “Napure Mirror” HAIR CHECK-UP MIRROR	12
■ “Napure Mirror” PREMIUM 3-WAY MIRROR	13
■ “Napure Mirror” STAND MIRROR	14,15
■ “Napure Mirror” STAND & HAND MIRROR	16
■ “Napure Mirror” Other types of Mirrors	17
■ EYE MAKEUP MIRROR	18,19
■ UV-DETECTION MIRROR	20,21
■ “SPACE MIRROR” Break-proof Mirrors with two-sided adhesive tape	22
■ “SPACE MIRROR” Break-proof Mirrors with detachable adhesive tape	23
■ PHOTO DISPLAY MIRROR	24
■ EVER-CLEAR MIRROR	25
■ STAND MIRROR	26,27,28
■ COMPACT MIRROR	29
■ Other types of mirrors, CLIP-ON VANITY MIRROR	30
■ Other types of mirrors, PROFESSIONAL MODEL MAGNIFICATION MIRROR	31
■ Other types of mirrors	32
■ Mirrors for Sales Promotion Items	33,34,35

MIRRORS Manufactured at HIRANO in OSAKA HORIUCHI MIRROR INDUSTRY CO., LTD.

We design, manufacture and sell various mirror products at our office and factory.

We are supplying various items of the patented "Napure Mirror"

including hand mirrors, compact mirrors and stand mirrors,

which are convenient and clearly reflect your beauty.

Company Profile

Name Horiuchi Mirror Industry Co., Ltd.

Address 1-5-11 Nishiwaki, Hirano-Ku, Osaka-Shi, Osaka 547-0035, Japan

TEL : +81-6-6702-1987

FAX : +81-6-6702-5003

e-mail horiiuchi@cr-horiuchi.co.jp

HP <http://www.cr-horiuchi.co.jp>

Representative HORINOUCI Shigemi, President

Established in April, 1955

Capital ¥10,000,000

Employees 13

Major bank Hirano Branch of Sumitomo Mitsui Banking Corporation

Business Area Manufacture of various types of mirror products including stand mirrors, compact mirrors, hand mirrors, etc.



Osaka products

"Napure Mirror", PROFESSIONAL MODEL FOLDABLE STAND MIRROR Certified as the "OSAKA-SEI Brand (Made-in-Osaka Brand)" by Osaka Prefectural Government

The items of "Napure Mirror", PROFESSIONAL MODEL FOLDABLE STAND MIRROR are shown in detail on the pages 4 to 7.



"Napure Mirror" is a high-class mirror more excellent than others and reflects the real color of your skin as seen by others.

Do you think that the conventional mirrors reflect real color of your skin?



Actually, the color of your skin reflected by the conventional mirrors is slightly different from the color seen by other people.

The conventional mirrors do not reflect the real color of your skin.

The conventional mirrors have failed to correctly reflect the color of your skin. The mirrors reflect white color into slightly yellowish white and make other colors dull. So your face looks pale.

And makeup with a conventional mirror may cause troubles, for example !



... because of incorrectly reflected colors !

"Napure Mirror", on the contrary, reflects the real color of your skin,

more naturally and beautifully than any other mirrors do. The correctly reflected color of your skin enables you to apply makeup with properly selected colors.

The items of "Napure Mirror" have been employed as the training aids by Tokyo Beauty Advisor School.

The instructors and trainees praise the mirrors with the message, "The mirrors clearly reflect the color of human skin and are the best makeup items."



This is the feature of the gloss and reflection of the patented "Napure Mirror".

Glass of high clarity



Reflective metal layer by vacuum deposition



"Napure Mirror" reflects natural pure colors with minimum change.



↑ Cross section of Napure Mirror



↑ Cross section of the mirror

The glass used for the conventional mirrors contains considerable amount of iron to absorb blue light of the incident light and make white color look dull. We have developed "Napure Mirror" made of clear glass with minimum iron content. "Napure Mirror" rarely changes the reflected colors to show natural and pure colors without influence by the glass. Thus "Napure Mirror" is the most suitable for matching the foundation to the colors of your skin and partial makeup. *The photos show an image of reflection.

Comparison in reflection (in our test)

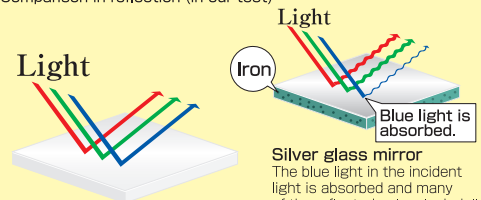

Napure Mirror
The mirror of ultra-clear plate glass reflects natural and pure colors with minimum change.

The line of "Napure Mirror" items reflect the natural color of your skin and your beauty. New items are produced one after another responding to the good reputation.



HAIR CHECK-UP MIRROR

MAGNIFICATION MIRROR COMPACT

HAND

STAND

PROFESSIONAL MODEL MIRROR

PREMIUM 3-WAY MIRROR

Gloss and reflection proved by the patent

The patented "Napure Mirror"

*Please be careful not to mistake similar products for "Napure Mirror".



made in JAPAN

Patented mirror made in Japan! Reflects the real color of human skin!

Made of Napure Mirror made in JAPAN

Horiuchi Mirror Industry Co., Ltd.



1 Manufacturing process

Ultra-clear glass plates (914 mm x 600 mm) free of contaminants are washed, and an aluminum layer is deposited with a vacuum-deposition machine for 15 min. The mirror with vacuum-deposited aluminum layer reflects everything clearly and is safe for human and natural environment owing to the lead-free painting applied for the protective layer of the mirror.



2 Cutting and beveling

The mirrors are automatically precut by the CNC cutter according to the dimensional data sent from the CAD system to the cutter, and cut apart manually by the craftsman.



3 Framing

Automatic framing machine operating around-the-clock. The mirrors are fitted with plastic frames automatically.

3 Welding

The materials are fused and adhered by high frequency wave. The technique is employed for manufacturing the PROFESSIONAL MODEL FOLDABLE STAND MIRRORS.



4 Assembly, inspection and packing

Each piece of "Napure Mirror" is carefully assembled with a frame. The assembled items are inspected visually and with measuring instruments. The items of "Napure Mirror" passing the strict inspection are packed and shipped.

Napure Mirror, Gloss and reflection proved by the patent

A high-class mirror more excellent than others to reflect the real color of your skin as seen by others

High Class Mirror



Professional Model Foldable Stand Mirror with the cute cat pattern of CoCoLand
PROFESSIONAL MODEL FOLDABLE STAND Napure Mirror, CoCoLand®

Which cat pattern will you select?



Mew....



Cats on musical score pattern
CL-02



Walking cats
CL-05



For easy makeup!
Slant adjustable to three positions

Professional Model Foldable Stand Mirror with the cute cat pattern of CoCoLand PROFESSIONAL MODEL FOLDABLE STAND Napure Mirror CoCoLand®

Product name	Item Code	Suggested retail price	Size	Pattern	JAN	Quantity per carton	Material
PROFESSIONAL MODEL FOLDABLE STAND Napure Mirror, CoCoLand® (M)	CL-02	¥1,400 and tax	[Product]125mm×175mm×15mm [Package]135mm×195mm×15mm	Cats on musical score pattern	773333	60	[Frame] cotton fabric
	CL-05		[Weight]200g(Net weight) 205g(Gross weight)	Walking cats	773364		[Mirror] Napure Mirror

Slant adjustable to three positions

Cute-adult style!

Professional Model Foldable Stand Mirror with the pretty lace pattern



Gold : HP-37G



Silver : HP-37SV

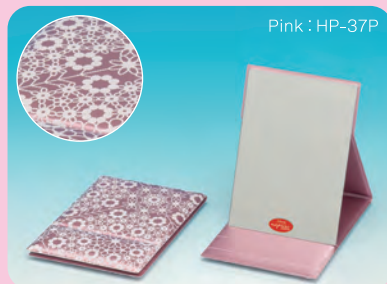

Pink : HP-37P



Blue : HP-37BL



For easy makeup!
Slant adjustable to three positions

Professional Model Foldable Stand Mirror with the lace pattern
PROFESSIONAL MODEL FOLDABLE STAND Napure Mirror Lace pattern

Product name	PROFESSIONAL MODEL FOLDABLE STAND Napure Mirror, Lace pattern (M)
Item Code	[Gold] HP-37G [Silver] HP-37SV [Pink] HP-37P [Blue] HP-37BL
Suggested retail price	¥1,500 and tax
Size	[Product]125mm×175mm×15mm [Package]135mm×195mm×15mm [Weight]205g(Net weight) / 210g(Gross weight)
Color	Gold / Silver / Pink / Blue
JAN	[Gold] 773371 [Silver] 773388 [Pink] 773395 [Blue] 773401
Quantity per carton	60
Material	[Frame]PU resin [Mirror]Napure Mirror

Slant adjustable to three positions

The patented Napure Mirror (Japanese Patent No. 3732490)

Napure Mirror, Gloss and reflection proved by the patent

A high-class mirror more excellent than others to reflect the real color of your skin as seen by others

High Class Mirror

Napure Mirror



For easy makeup!
Slant adjustable
to 3 positions



Floral (pink)



Floral (blue)



Polka dot (pink)



Polka dot (blue)



Stripe (red)



Stripe (navy)

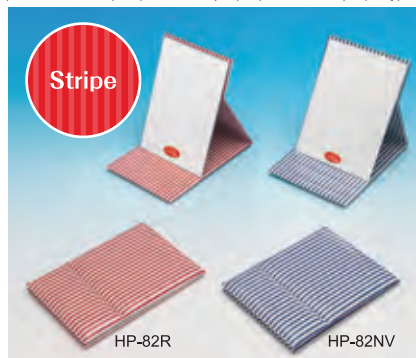

Professional Model Foldable Stand Mirrors with Floral, Polka dot and Stripe patterns PROFESSIONAL MODEL FOLDABLE STAND Napure Mirror Floral Polka dot Stripe

Product name	Item Code	Suggested retail price	Size	Pattern	JAN	Quantity per carton	Material
PROFESSIONAL MODEL FOLDABLE STAND Napure Mirror, Floral (M)	pink HP-80P	¥1,400 and tax	[Product]125mm×175mm×15mm [Package]135mm×195mm×15mm [Weight]200g(Net weight) 205g(Gross weight)	Floral (pink)	773098	60	[Frame] cotton fabric [Mirror] Napure Mirror
	blue HP-80BL			Floral (blue)	773104		
PROFESSIONAL MODEL FOLDABLE STAND Napure Mirror, Polka dot (M)	pink HP-81P			Polka dot (pink)	773111		
	blue HP-81BL			Polka dot (blue)	773128		
PROFESSIONAL MODEL FOLDABLE STAND Napure Mirror, Stripe (M)	red HP-82R			Stripe (red)	773135		
	navy HP-82NV			Stripe (navy)	773142		

napure MIRROR Slant adjustable to three positions

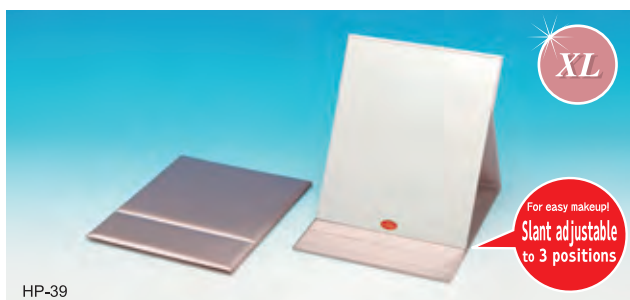
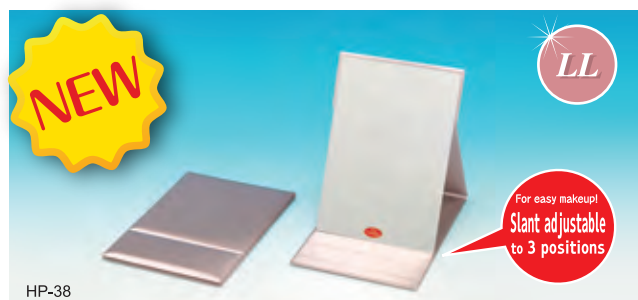

Professional Model Foldable Stand Mirror made of Napure Mirror, Gold PROFESSIONAL MODEL FOLDABLE STAND MIRROR LL 3L

Product name	Item Code	Suggested retail price	Size	Color	JAN	Quantity per carton	Material
PROFESSIONAL MODEL FOLDABLE STAND Napure Mirror	(LL) HP-38	¥2,900 and tax	[Product]185mm×280mm×15mm [Package]195mm×300mm×20mm [Weight]495g(Net weight)/505g(Gross weight)	Gold	773470	40	[Frame] PVC resin
	(XL) HP-39	¥3,900 and tax	[Product]255mm×320mm×15mm [Package]265mm×330mm×20mm [Weight]770g(Net weight)/885g(Gross weight)	Gold	773487	20	[Mirror] Napure Mirror

napure MIRROR Slant adjustable to three positions



Professional Model Foldable Stand Mirror made of Napure Mirror, MINI PROFESSIONAL MODEL FOLDABLE STAND MIRROR mini

Product name	Item Code	Suggested retail price	Size	Color	JAN	Quantity per carton	Material
PROFESSIONAL MODEL FOLDABLE STAND Napure Mirror, MINI	HP-36BK	¥650 and tax	[Product]80mm×110mm×12mm [Mirror size]72mm×100mm×2mm [Package]90mm×135mm×15mm [Weight]70g(Net weight)/72g(Gross weight)	Black	773210	144	[Frame]PVC resin [Mirror] Napure Mirror
	HP-36P			Pink	773227		
	HP-36W			White	773234		

napure MIRROR Slant adjustable to three positions

*Do not give impact to the mirrors by dropping off, etc. Impacted mirrors may break and hurt the user. *The metal parts of the mirrors are deteriorated when stored at high temperature and humidity for a long time. *Chemicals sticking on the mirrors must be wiped off with dry cloth.

*Each of the "JAN codes" given in six digits in this catalogue constitutes the product code and check digit, and follows the code, 4510510 indicating the country and manufacturer codes.

The patented Napure Mirror (Japanese Patent No. 3732490)

Napure Mirror, Gloss and reflection proved by the patent

A high-class mirror more excellent than others to reflect the real color of your skin as seen by others

High Class Mirror



PROFESSIONAL MODEL



HP-60



HP-61

Eco-friendly EVA-Resin-Framed Professional Model Foldable Stand Mirror, made of Napure Mirror, Pink PROFESSIONAL MODEL FOLDABLE STAND MIRROR **eco**

Product name	PROFESSIONAL MODEL FOLDABLE STAND Napure Mirror, ECO, with the slant adjustable to three positions, Pink (M)
Item Code.	HP-60
Suggested retail price	¥1,100 and tax
Size	125mm×175mm
Color	Pink
JAN	772350
Quantity per carton	120
Material	[Frame]EVA resin [Mirror]Napure Mirror

napure **eco** Slant adjustable to three positions

Product name	PROFESSIONAL MODEL FOLDABLE STAND Napure Mirror, ECO, with the slant adjustable to three positions, Pink (L)
Item Code.	HP-61
Suggested retail price	¥2,000 and tax
Size	175mm×225mm
Color	Pink
JAN	772367
Quantity per carton	60
Material	[Frame]EVA resin [Mirror]Napure Mirror

napure **eco** Slant adjustable to three positions



HP-50



HP-51

Eco-friendly EVA-Resin-Framed Professional Model Foldable Stand Mirror, made of Napure Mirror PROFESSIONAL MODEL FOLDABLE STAND MIRROR **eco**

Product name	PROFESSIONAL MODEL FOLDABLE STAND Napure Mirror, ECO (M)
Item Code.	HP-50
Suggested retail price	¥1,200 and tax
Size	125mm×175mm
Color	Black
JAN	772114
Quantity per carton	120
Material	[Frame]EVA resin [Mirror]Napure Mirror

napure **eco**

Product name	PROFESSIONAL MODEL FOLDABLE STAND Napure Mirror, ECO (L)
Item Code.	HP-51
Suggested retail price	¥2,200 and tax
Size	175mm×225mm
Color	Black
JAN	772121
Quantity per carton	60
Material	[Frame]EVA resin [Mirror]Napure Mirror

napure **eco**



HP-52



HP-53

Eco-friendly EVA-Resin-Framed Professional Model Foldable Stand Mirrors made of Napure Mirror, with the slant adjustable to three positions PROFESSIONAL MODEL FOLDABLE STAND MIRROR **eco**

Product name	PROFESSIONAL MODEL FOLDABLE STAND Napure Mirror, ECO, with the slant adjustable to three positions (LL)
Item Code.	HP-52
Suggested retail price	¥2,900 and tax
Size	185mm×280mm
Color	Black
JAN	772190
Quantity per carton	40
Material	[Frame]EVA resin [Mirror]Napure Mirror

napure **eco** Slant adjustable to three positions

Product name	PROFESSIONAL MODEL FOLDABLE STAND Napure Mirror, ECO, with the slant adjustable to three positions (XL)
Item Code.	HP-53
Suggested retail price	¥3,900 and tax
Size	255mm×320mm
Color	Black
JAN	772206
Quantity per carton	20
Material	[Frame]EVA resin [Mirror]Napure Mirror

napure **eco** Slant adjustable to three positions

*Do not give impact to the mirrors by dropping off, etc. Impacted mirrors may break and hurt the user. *The metal parts of the mirrors are deteriorated when stored at high temperature and humidity for a long time. *Chemicals sticking on the mirrors must be wiped off with dry cloth.

*Each of the "JAN codes" given in six digits in this catalogue constitutes the product code and check digit, and follows the code, 4510510 indicating the country and manufacturer codes.

The patented Napure Mirror (Japanese Patent No. 3732490)

Napure Mirror, Gloss and reflection proved by the patent

A high-class mirror more excellent than others to reflect the real color of your skin as seen by others

High Class Mirror

napure mirror



Professional Model Foldable Stand Mirrors made of Napure Mirror with Colored Frames PROFESSIONAL MODEL FOLDABLE STAND MIRROR

Product name	PROFESSIONAL MODEL FOLDABLE STAND Napure Mirror with Colored Frame (M)	PROFESSIONAL MODEL FOLDABLE STAND Napure Mirror with Colored Frame (L)
Item Code.	HP-40	HP-41
Suggested retail price	¥1,200 and tax	¥2,000 and tax
Size	125mm × 175mm	175mm × 225mm
Color	Pink / Blue / Yellow / Black	Pink / Blue / Yellow / Black
JAN	[Pink] 772039 [Blue] 772046 [Yellow] 772053 [Black] 772060	[Pink] 772077 [Blue] 772084 [Yellow] 772091 [Black] 772107
Quantity per carton	120	60
Material	[Frame] PVC resin [Mirror] Napure Mirror	[Frame] PVC resin [Mirror] Napure Mirror



PRO MODEL



Professional Model Foldable Stand Mirror made of Napure Mirrors with Metallic-colored Frames, with the slant adjustable to three positions

Product name	PROFESSIONAL MODEL FOLDABLE STAND Napure Mirror with Metallic-colored Frame (M)
Item Code.	HP-34
Suggested retail price	¥1,200 and tax
Size	125mm × 175mm
Color	Silver / Gold
JAN	[Silver] 772213 [Gold] 772220
Quantity per carton	120
Material	[Frame] PVC resin [Mirror] Napure Mirror

Slant adjustable to three positions



PROFESSIONAL MODEL FOLDABLE STAND MIRROR

Product name	PROFESSIONAL MODEL FOLDABLE STAND Napure Mirror with Magnification Mirror (L)
Item Code.	HP-35
Suggested retail price	¥2,200 and tax
Size	175mm × 225mm
Color	Silver / Gold
JAN	[Silver] 772237 [Gold] 772244
Quantity per carton	60
Material	[Frame] PVC resin [Mirror] Napure Mirror

Slant adjustable to three positions



Professional Model Foldable Stand Mirrors made of Napure Mirror with Magnification Mirror PROFESSIONAL MODEL FOLDABLE STAND MIRROR

Product name	PROFESSIONAL MODEL FOLDABLE STAND Napure Mirror with Magnification Mirror (M)	PROFESSIONAL MODEL FOLDABLE STAND Napure Mirror with Magnification Mirror (L)
Item Code.	HP-42	HP-43
Suggested retail price	¥1,400 and tax	¥2,600 and tax
Size	125mm × 175mm	175mm × 225mm
Color	Black	Black
JAN	772152	772169
Quantity per carton	120	60
Material	[Frame] PVC resin [Mirror] Napure Mirror	[Frame] PVC resin [Mirror] Napure Mirror

MAGNIFICATION ② *The 2x magnification mirror is made of a concave mirror having the radius of curvature (R) of 1000.

Professional Model Foldable Stand Mirrors used in the lesson.

Our Professional Model Foldable Stand Mirrors have been employed for the training aids by Tokyo Beauty Advisor School where beauty experts are trained. The instructors and trainees praised the mirrors with the message, "The mirrors clearly reflect the color of human skin and are the best makeup items."

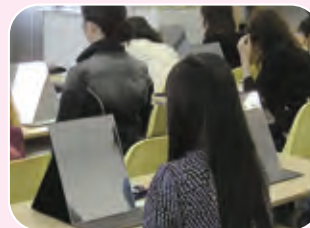

[Precaution for use]*The magnification mirrors may focus the sun's rays to burn up a combustible material and cause fire. So do not use or store the magnification mirrors under direct sunlight. *At first, move your face close to the magnification mirror and then move away from the mirror to find the focal point you can see clearly reflected image. *Do not look at the magnified image too long. It may cause eyestrain or make you feel sick.

*Do not give impact to the mirrors by dropping off, etc. Impacted mirrors may break and hurt the user. *The metal parts of the mirrors are deteriorated when stored at high temperature and humidity for a long time. *Chemicals sticking on the mirrors must be wiped off with dry cloth.

*Each of the "JAN codes" given in six digits in this catalogue constitutes the product code and check digit, and follows the code, 4510510 indicating the country and manufacturer codes.

The patented Napure Mirror (Japanese Patent No. 3732490)

Napure Mirror, Gloss and reflection proved by the patent

A high-class mirror more excellent than others to reflect the real color of your skin as seen by others

High Class Mirror

-  COMPACT
-  STAND&HAND
-  STAND



While you are going out...
Handy and portable compact mirror



Used anywhere...
Convenient stand & hand mirror



At your home...
Stand mirror with freely adjustable slant

Magnifies your face to the details
MAGNIFICATION MIRROR



Patented "Napure Mirror" reflecting the real color of your skin
Napure Mirror

特許 第3732490号

MAGNIFICATION Mirror with PLAIN Napure Mirror

The magnification mirror magnifies your face to the details and is suitable to care keratin plugs, mottles and wrinkles on your skin.

Images are magnified in concave mirrors and enlarged more with the increase of their curvature.

The magnification of our mirrors is roughly indicated by the radius of curvature (abbreviated as "R") of the mirrors. A magnification mirror having smaller radius of curvature (R) has greater curvature, in other words, reflects a larger image.



Plain mirror
Napure Mirror

For checking the color of your skin and selecting suitable makeup coloring



2x
Concave mirror of 1000R

Good for the makeup on the whole of your face and for eye makeup



3x
Concave mirror of 600R

Good for applying a concealer and for eye makeup



5x
Concave mirror of 400R

Good for caring skin and eyebrows and for eye makeup



7x
Concave mirror of 300R

Good for eye makeup such as putting on false eyelashes

[Usage]

- At first, move your face close to the magnification mirror, and then move away from the mirror to find the focal point where you can see clearly reflected image.
- A mirror of greater curvature has shorter focal length, in other words, you can see a clear image nearer to the mirror surface.
- A high-magnification mirror gives vague image outside the focal point.
- Do not look at the magnified image too long. It may cause eyestrain or make you feel sick.

*The plain mirror is made of the patented "Napure Mirror" and the magnification mirror is made of a conventional mirror.

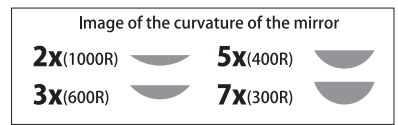

What is "Napure Mirror" used as the plain mirror?

The mirror reflecting the real color of your skin as seen by others
The most suitable mirror for matching the colors of your skin and a foundation and for partial makeup

Glass of high clarity + Reflective metal layer by vacuum deposition =



Glass of high clarity

The glass used for the conventional mirrors contains considerable amount of iron to absorb blue light of the incident light and make white color look dull. We have developed "Napure Mirror" made of clear glass with minimum iron content. "Napure Mirror" rarely changes the reflected colors to show natural and pure colors without influence by the glass. Thus "Napure Mirror" is the most suitable for matching the foundation to the colors of your skin and partial makeup. *The photos show an image of reflection.

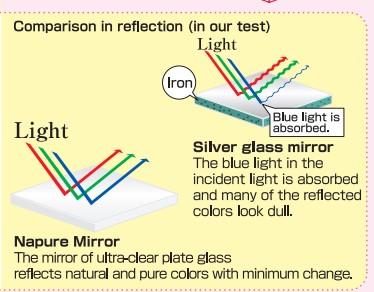
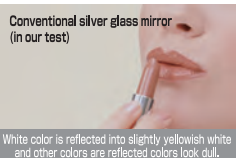
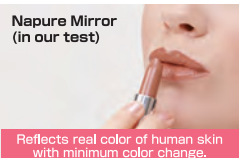
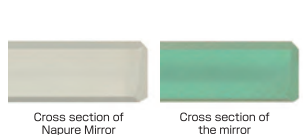

*The photo shows an image of reflection.

Napure Mirror, Gloss and reflection proved by the patent

A high-class mirror more excellent than others to reflect the real color of your skin as seen by others

High Class Mirror

Magnification mirror!
Magnifies your face to the details!

2x **3x** **5x** **7x**

Concave mirror of 1000R Concave mirror of 600R Concave mirror of 400R Concave mirror of 300R

Compact mirrors with the combination of a plain mirror made of Napure Mirror reflecting the real color of your skin and a magnification mirror made of conventional mirror magnifying your face to the details



Plain mirror
Napure Mirror



COMPACT MIRROR

Product name	Item Code	Suggested retail price	Size	Color	JAN	Quantity per carton	Material
2x MAGNIFICATION COMPACT MIRROR with PLAIN Napure Mirror	RC-02SV	¥1,500 and tax	110mm x 117mm	Silver	772541	120	[Frame]ABS resin [Mirror]conventional glass magnification mirror and plain Napure Mirror
	RC-02BK			Black	772565		
3x MAGNIFICATION COMPACT MIRROR with PLAIN Napure Mirror	RC-03SV	¥1,600 and tax		Silver	772572	120	
	RC-03BK			Black	772596		
5x MAGNIFICATION COMPACT MIRROR with PLAIN Napure Mirror	RC-05SV	¥1,700 and tax		Silver	772602	120	
	RC-05BK			Black	772626		
7x MAGNIFICATION COMPACT MIRROR with PLAIN Napure Mirror	RC-07SV	¥1,800 and tax		Silver	772633	120	
	RC-07BK			Black	772657		

Magnification mirror!
Magnifies your face to the details!

2x **3x** **5x** **7x**

Concave mirror of 1000R Concave mirror of 600R Concave mirror of 400R Concave mirror of 300R

Stand & hand mirrors with the combination of a plain mirror made of Napure Mirror reflecting the real color of your skin and a magnification mirror made of conventional mirror magnifying your face to the details



Plain mirror
Napure Mirror



STAND HAND MIRROR

Product name	Item Code	Suggested retail price	Size	Color	JAN	Quantity per carton	Material
2x MAGNIFICATION STAND & HAND MIRROR with PLAIN Napure Mirror	RH-02SV	¥1,500 and tax	123mm x 210mm	Silver	772664	120	[Frame]ABS resin [Mirror]conventional glass magnification mirror and plain Napure Mirror
	RH-02BK			Black	772688		
3x MAGNIFICATION STAND & HAND MIRROR with PLAIN Napure Mirror	RH-03SV	¥1,600 and tax		Silver	772695	120	
	RH-03BK			Black	772718		
5x MAGNIFICATION STAND & HAND MIRROR with PLAIN Napure Mirror	RH-05SV	¥1,700 and tax		Silver	772725	120	
	RH-05BK			Black	772749		
7x MAGNIFICATION STAND & HAND MIRROR with PLAIN Napure Mirror	RH-07SV	¥1,800 and tax		Silver	772756	120	
	RH-07BK			Black	772770		

Magnification mirror!
Magnifies your face to the details!

2x **3x** **5x** **7x**

Concave mirror of 1000R Concave mirror of 600R Concave mirror of 400R Concave mirror of 300R

Stand mirrors with the combination of a plain mirror made of Napure Mirror reflecting the real color of your skin and a magnification mirror made of conventional mirror magnifying your face to the details



Plain mirror
Napure Mirror



STAND MIRROR

Product name	Item Code	Suggested retail price	Size	Color	JAN	Quantity per carton	Material
2x MAGNIFICATION STAND MIRROR with PLAIN Napure Mirror	RS-02	¥2,300 and tax	170mm x 295mm	Silver	772787	48	[Frame]aluminum and steel [Mirror]conventional glass magnification mirror and plain Napure Mirror
3x MAGNIFICATION STAND MIRROR with PLAIN Napure Mirror	RS-03	¥2,400 and tax			772794		
5x MAGNIFICATION STAND MIRROR with PLAIN Napure Mirror	RS-05	¥2,500 and tax			772800		
7x MAGNIFICATION STAND MIRROR with PLAIN Napure Mirror	RS-07	¥2,600 and tax			772817		

The magnification mirrors may focus the sun's rays to burn up a combustible material and cause fire. So do not use or store the magnification mirrors under direct sunlight.

*Do not give impact to the mirrors by dropping off, etc. Impacted mirrors may break and hurt the user. *The metal parts of the mirrors are deteriorated when stored at high temperature and humidity for a long time. *Chemicals sticking on the mirrors must be wiped off with dry cloth.

*Each of the "JAN codes" given in six digits in this catalogue constitutes the product code and check digit, and follows the code, 4510510 indicating the country and manufacturer codes.



STAND



The patented Napure Mirror (Japanese Patent No. 3732490)

Napure Mirror, Gloss and reflection proved by the patent

A high-class mirror more excellent than others to reflect the real color of your skin as seen by others

High Class Mirror

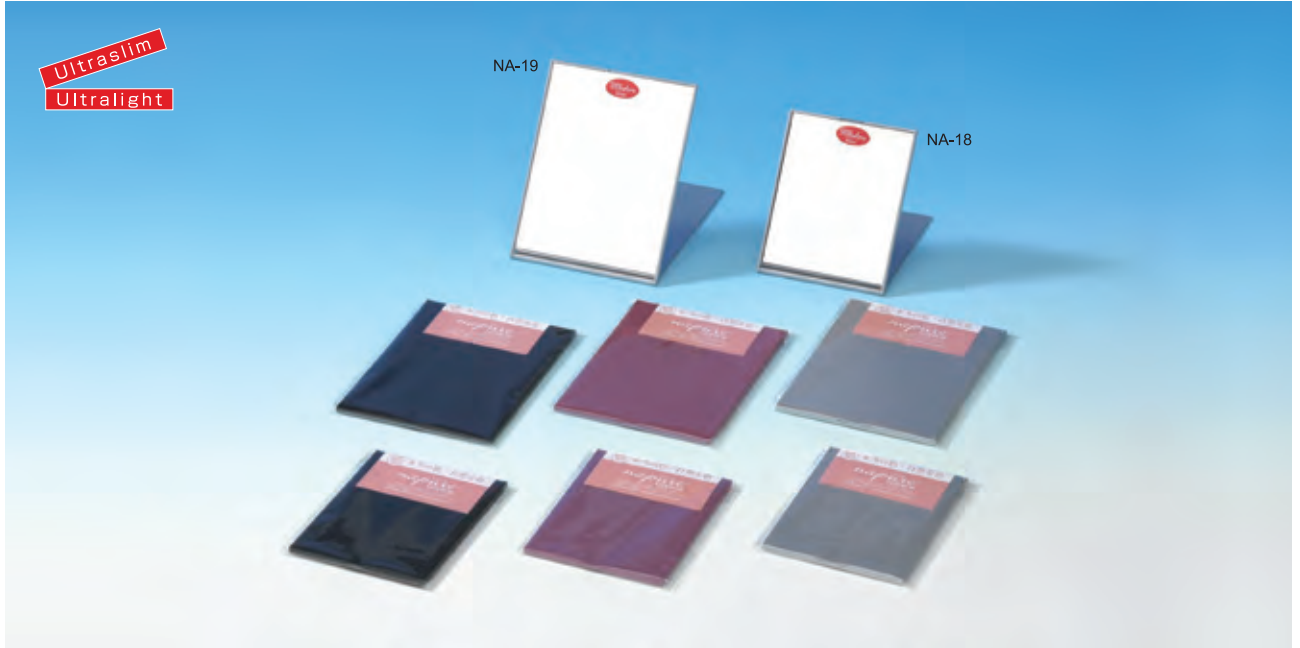

Slim & Light Compact Mirror made of Napure Mirror **SLIM & LIGHT COMPACT MIRROR**

Product name	Item Code.	Suggested retail price	Size	Color	JAN	Quantity per carton	Material
SLIM & LIGHT COMPACT Napure Mirror (M)	NA-18	¥800 and tax	104mm×130mm×4.5mm	Metallic silver	771346	180	[Frame]ABS resin [Mirror]Napure Mirror
				Metallic red	771353		
				Metallic black	771360		
SLIM & LIGHT COMPACT Napure Mirror (L)	NA-19	¥1,000 and tax	124mm×160mm×4.5mm	Metallic silver	771377	120	[Frame]ABS resin [Mirror]Napure Mirror
				Metallic red	771384		
				Metallic black	771391		

Ultraslim & Ultralight

So cute! Miniature Compact Mirror **COMPACT Napure Mirror MINI**



Cute Compact Mirror Made of Napure Mirror, MINI! **COMPACT Napure Mirror, MINI**

Product name	Item Code.	Suggested retail price	Size	Color	JAN	Quantity per carton	Material
COMPACT Napure Mirror, MINI	NA-32	¥380 and tax	[Product]53mm×85mm×5.5mm [Gross weight]56mm×117mm×8mm [Weight]27g(Net weight) / 30g(Gross weight)	Black	773036	240	[Frame]PS resin [Mirror]Napure Mirror
				Pink	773043		
				White	773050		

Fancy

*Do not give impact to the mirrors by dropping off, etc. Impacted mirrors may break and hurt the user. *The metal parts of the mirrors are deteriorated when stored at high temperature and humidity for a long time. *Chemicals sticking on the mirrors must be wiped off with dry cloth.

*Each of the "JAN codes" given in six digits in this catalogue constitutes the product code and check digit, and follows the code, 4510510 indicating the country and manufacturer codes.

The patented Napure Mirror (Japanese Patent No. 3732490)

Napure Mirror, Gloss and reflection proved by the patent

A high-class mirror more excellent than others to reflect the real color of your skin as seen by others

High Class Mirror



Compact Mirrors Made of Napure Mirror COMPACT MIRROR

Product name	COMPACT Napure Mirror (M) COMPACT Napure Mirror (L)
Item Code.	(M)NA-001 (L)NA-002
Suggested retail price	(M)¥700 and tax (L)¥900 and tax
Size	(M) 103mm×143mm (L) 125mm×168mm
Color	Silver
JAN	(M) 121912 (L) 121929
Quantity per carton	(M) 120 (L) 96
Material	[Frame]PS resin [Mirror]Napure Mirror



Double-sided Compact Mirrors Made of Napure Mirror MAGNIFICATION COMPACT MIRROR

Product name	Item Code.	Suggested retail price	Size	Color	JAN	Quantity per carton	Material
DOUBLE-SIDED COMPACT MIRROR with 2x MAGNIFICATION and PLAIN Napure Mirrors	Nzc-02	¥1,300 and tax	78mm×125mm	Metallic silver	771445	120	[Frame]ABS resin [Mirror]Napure Mirror
				Metallic red	771452		
				Metallic black	771469		
DOUBLE-SIDED COMPACT MIRROR with 3x MAGNIFICATION and PLAIN Napure Mirrors	Nzc-03	¥1,500 and tax	78mm×125mm	Metallic silver	771476	120	[Frame]ABS resin [Mirror]Napure Mirror
				Metallic red	771483		
				Metallic black	771490		



*The 2x magnification and 3x magnification mirrors are made of concave mirrors having the radiuses of curvature (R) of 1000 and 600 respectively.

[Precaution for use] The magnification mirrors may focus the sun's rays to burn up a combustible material and cause fire. So do not use or store the magnification mirrors under direct sunlight. *At first, move your face close to the magnification mirror and then move away from the mirror to find the focal point you can see clearly reflected image. *Do not look at the magnified image too long. It may cause eyestrain or make you feel sick.

*Do not give impact to the mirrors by dropping off, etc. Impacted mirrors may break and hurt the user. *The metal parts of the mirrors are deteriorated when stored at high temperature and humidity for a long time. *Chemicals sticking on the mirrors must be wiped off with dry cloth.

*Each of the "JAN codes" given in six digits in this catalogue constitutes the product code and check digit, and follows the code, 4510510 indicating the country and manufacturer codes.

NEW

napure[®] MIRROR

"Napure Mirror" is a high-class mirror more excellent than others and reflects the real color of your skin as seen by others.

PAT.3732490

Napure HAIR CHECK-UP MIRROR

For permanently keeping your beautiful hair
You can check the top of your head and the hair whorl.
Convenient for hair dyeing and wearing a wig.



For daily makeup...
Napure Mirror reflects the real color of your skin as seen by others. Good for your daily makeup!

For hair dyeing...
The bottom mirror reflects the top of your head and the hair whorl. You can easily dye your hair or wear a wig with best finish.

For wearing a wig...
The bottom mirror reflects the top of your head and the hair whorl. You can easily dye your hair or wear a wig with best finish.



The bottom mirror reflects the top of your head and the hair whorl.

Designed in a small size

For your daily makeup as a stand mirror

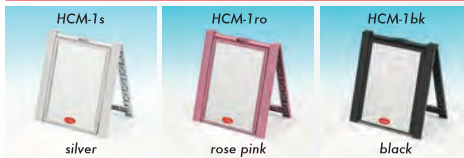

Usage of HAIR CHECK-UP MIRROR *Do not lift the frame not to make the front mirror slide off the frame.

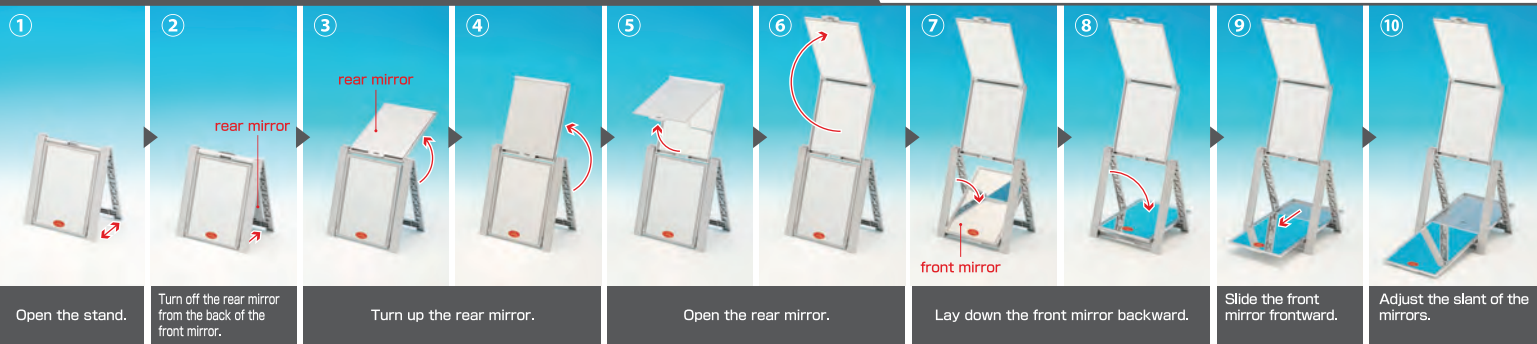

What is "Napure Mirror"?

The mirror reflecting the real color of your skin as seen by others

The most suitable mirror for matching the colors of your skin and afoundation and for partial makeup

Glass of high clarity

The glass used for the conventional mirrors contains considerable amount of iron to absorb blue light of the incident light and make white color look dull. We have developed "Napure Mirror" made of clear glass with minimum iron content. "Napure Mirror" rarely changes the reflected colors to show natural and pure colors without influence by the glass. Thus "Napure Mirror" is the most suitable for matching the foundation to the colors of your skin and partial makeup.

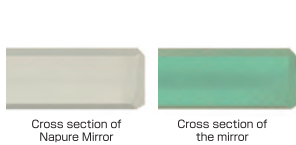

Glass of high clarity + Reflective metal layer by vacuum deposition = "Napure Mirror" reflects natural pure colors with minimum change.

Comparison in reflection (in our test)

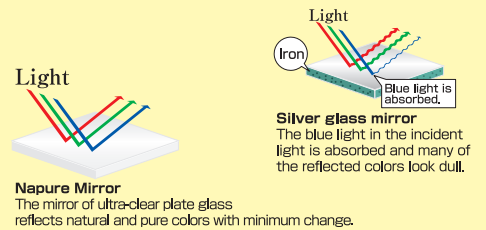

*The photo shows an image of reflection.

HAIR CHECK-UP MIRROR

*The specification and suggested retail price may be changed.

Product name	Item Code	Suggested retail price	Size	Color	JAN	Quantity per carton	Material
HAIR CHECK-UP MIRROR Napure Mirror	HCM-1	¥5,000 and tax	[Product]w176mm×h196mm×d20mm (The longest:about w176mm×h490mm×d320mm) [Package]w188mm×h205mm×d32mm	Silver Rose pink Black	773586 773609 773616	24	[Frame]ABS resin [Mirror]Napure Mirror

*Do not lift the frame. It may make the front mirror slide off the frame to break or injure the user. When the front mirror slides off, put it back into the frame.

*Do not give impact to the mirrors by dropping off, etc. Impacted mirrors may break and hurt the user. *The metal parts of the mirrors are deteriorated when stored at high temperature and humidity for a long time. *Chemicals sticking on the mirrors must be wiped off with dry cloth.

*Each of the "JAN codes" given in six digits in this catalogue constitutes the product code and check digit, and follows the code, 4510510 indicating the country and manufacturer codes.

Registered utility model Stand Mirror flexibly used according to the conditions of makeup

napure MIRROR PREMIUM 3-WAY MIRROR



Japanese Patent No. 3732490

What is "Napure Mirror"?

The mirror reflecting the real color of your skin as seen by others
The most suitable mirror for matching the colors of your skin and a foundation and for partial makeup

Glass of high clarity + Reflective metal layer by vacuum deposition =



Glass of high clarity

The glass used for the conventional mirrors contains considerable amount of iron to absorb blue light of the incident light and make white color look dull. We have developed "Napure Mirror" made of clear glass with minimum iron content. "Napure Mirror" rarely changes the reflected colors to show natural and pure colors without influence by the glass. Thus "Napure Mirror" is the most suitable for matching the foundation to the colors of your skin and partial makeup.

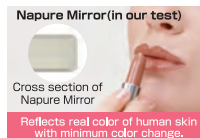

Comparison in reflection (in our test)

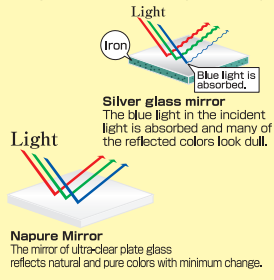

Direction Slant Height Free Style

The Napure Mirror reflects the real color of your skin.
Convenient for the makeup on the whole of your face and for partial makeup such as eye makeup.

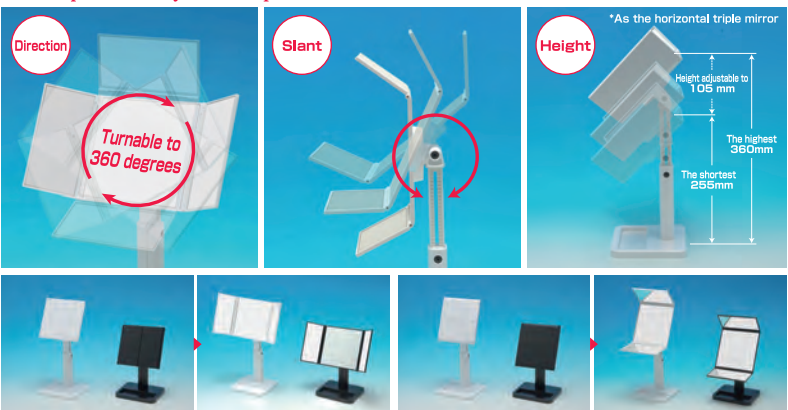

Knockdown stand mirror Flexibly used according to the conditions for makeup! PREMIUM 3-WAY MIRROR

Product name	PREMIUM 3-WAY MIRROR
Item Code.	[Black]NA-55BK [White]NA-55W
Suggested retail price	¥5,000 and tax
Size	Product(Horizontal triple mirror):W170mmxD140mmxH255mm(伸長時360mm)
	Product(Vertical triple mirror):W160mmxD140mmxH260mm(伸長時365mm)
	Mirror:front150mm×150mm／扉72mm×150mm
	三面開時最大幅:325mm×155mm
Package:	175mm×255mm×85mm
Weight	Net weight :590g / Gross weight:700g
Color	Black, White
JAN	[Black]772961 [White]772978
Quantity per carton	18
Material	[Knockdown type][Frame]ABS resin [Mirror]Napure Mirror

●Contents in the package: Framed mirror, Stand, two screws, two washers, Instruction manual
*The photos show an image of reflection.

*Each of the "JAN codes" given in six digits in this catalogue constitutes the product code and check digit, and follows the code, 4510510 indicating the country and manufacturer codes.

*Do not give impact to the mirrors by dropping off, etc. Impacted mirrors may break and hurt the user. *The metal parts of the mirrors are deteriorated when stored at high temperature and humidity for a long time. *Chemicals sticking on the mirrors must be wiped off with dry cloth.



Easily assembled Prepare a cross slot screw driver.

Procedure

- Put the frame into the stand.
- Set the washers on the screws, and fix the screws with the screw driver.

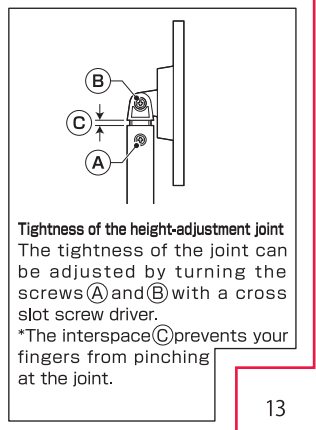
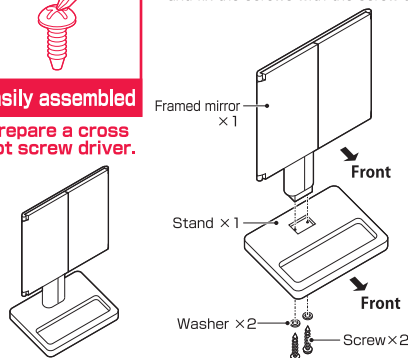



The patented Napure Mirror (Japanese Patent No. 3732490)

Napure Mirror, Gloss and reflection proved by the patent

A high-class mirror more excellent than others to reflect the real color of your skin as seen by others

High Class Mirror



STAND



Stand Mirrors with Plain and Magnification Mirrors made of Napure Mirror MAGNIFICATION STAND MIRROR

Product name	DOUBLE-SIDED STAND MIRROR with 2x MAGNIFICATION and PLAIN Napure Mirrors
Item Code.	NA-29
Suggested retail price	¥2,000 and tax
Size	170mm×200mm×90mm
Color	Silver
JAN	772251
Quantity per carton	48
Material	[Frame]aluminum and steel [Mirror]Napure Mirror

MAGNIFICATION ② Slant adjustable

*The 2x magnification mirror is made of a concave Napure Mirror having the radius of curvature (R) of 1000.

[Precaution for use]The magnification mirrors may focus the sun's rays to burn up a combustible material and cause fire. So do not use or store the magnification mirrors under direct sunlight. *At first, move your face close to the magnification mirror and then move away from the mirror to find the focal point you can see clearly reflected image. *Do not look at the magnified image too long. It may cause eyestrain or make you feel sick.



Simple Stand Mirrors made of Napure Mirror SIMPLE STAND MIRROR

Product name	SIMPLE-DESIGN STAND Napure Mirror(M)
Item Code.	NA-31
Suggested retail price	¥2,200 and tax
Size	198mm×242mm×25mm
Color	Black / Silver
JAN	[Black]772299 [Silver]772282
Quantity per carton	30
Material	[Frame]PS resin [Mirror]Napure Mirror

MAGNIFICATION ② Slant adjustable

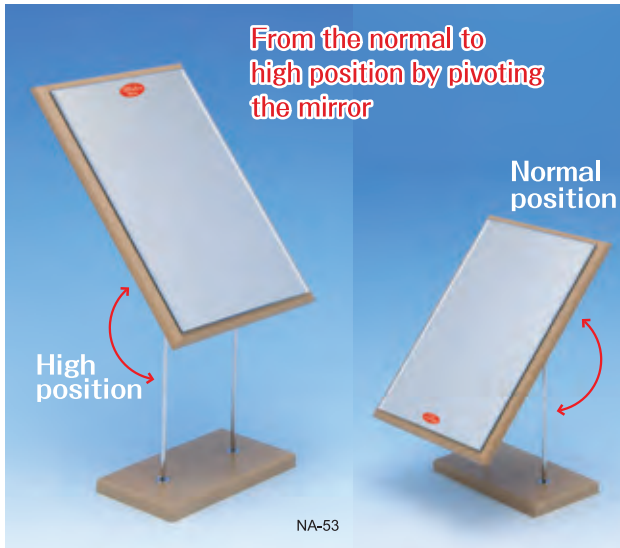

Height-adjustable Stand Mirrors made of Napure Mirror HEIGHT-ADJUSTABLE STAND MIRROR

Product name	HEIGHT-ADJUSTABLE STAND Napure Mirror
Item Code.	NA-53
Suggested retail price	¥3,900 and tax
Size	200mm×100mm×315mm(Normal) / 425mm(High)
Color	maple
JAN	771704
Quantity per carton	20
Material	[Frame]MDF (medium density fiberboard) [Mirror]Napure Mirror

Height adjustable Slant adjustable

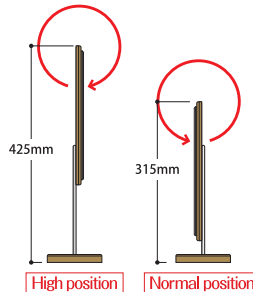

Height adjustable to two positions for easy makeup

The patented Napure Mirror (Japanese Patent No. 3732490)
Napure Mirror, Gloss and reflection proved by the patent

A high-class mirror more excellent than others to reflect the real color of your skin as seen by others

High Class Mirror

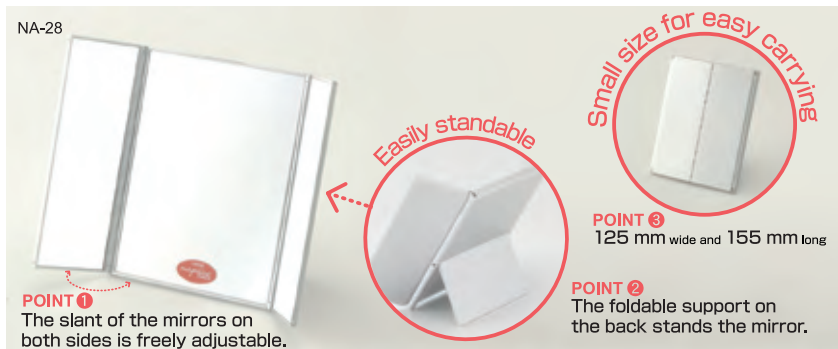

Tabletop 3-Way Mirror made of Napure Mirror
3-WAY STAND MIRROR

Product name	3-WAY STAND Napure Mirror
Item Code.	NA-28
Suggested retail price	¥1,400 and tax
Size	125mm×155mm
Color	Metallic silver
JAN	772138
Quantity per carton	60入
Material	[Frame]PS resin [Mirror]Napure Mirror

napure MIRROR Slant adjustable Triple-sided Mirror



STAND



Pendant Package

NA-26



Pendant Package

NA-27

Tabletop Mirrors made of Napure Mirror **STAND MIRROR**

Product name	Item Code.	Suggested retail price	Size	Color	JAN	Quantity per carton	Material
ALUMINUM-FRAMED STAND Napure Mirror (M)	NA-26	¥1,400 and tax	170mm×200mm	Silver	772015	60	[Frame]Aluminum [Mirror]Napure Mirror
ALUMINUM-FRAMED STAND Napure Mirror (L)	NA-27	¥1,700 and tax	220mm×200mm	Silver	772022	48	[Frame]Aluminum [Mirror]Napure Mirror

napure MIRROR Slant adjustable

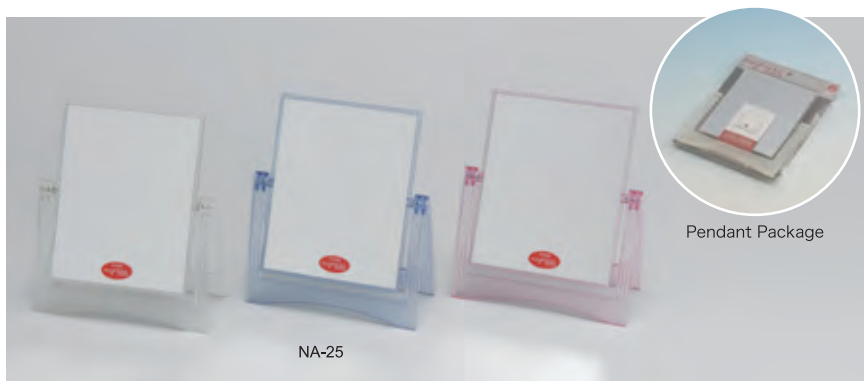

Pendant Package

NA-25

Tabletop Mirrors made of Napure Mirror
STAND MIRROR with COLORED FRAME

Product name	STAND Napure Mirror with COLORED FRAME
Item Code.	NA-25
Suggested retail price	¥900 and tax
Size	156mm×190mm
Color	Clear / Blue / Pink
JAN	[Clear]772008
	[Blue]771995
	[Pink]771988
Quantity per carton	72
Material	[Frame]PS resin [Mirror]Napure Mirror

napure MIRROR Slant adjustable

*Do not give impact to the mirrors by dropping off, etc. Impacted mirrors may break and hurt the user. *The metal parts of the mirrors are deteriorated when stored at high temperature and humidity for a long time. *Chemicals sticking on the mirrors must be wiped off with dry cloth.

*Each of the "JAN codes" given in six digits in this catalogue constitutes the product code and check digit, and follows the code, 4510510 indicating the country and manufacturer codes.



The patented Napure Mirror (Japanese Patent No. 3732490)

Napure Mirror, Gloss and reflection proved by the patent

A high-class mirror more excellent than others to reflect the real color of your skin as seen by others

High Class Mirror



HAND



NA-003

Stand and Hand Mirrors made of Napure Mirror STAND & HAND MIRROR

Product name	STAND & HAND Napure Mirror
Item Code.	NA-003
Suggested retail price	¥1,000 and tax
Size	127mm×213mm
Color	Silver
JAN	121936
Quantity per carton	120入
Material	[Frame]ABS resin [Mirror]Napure Mirror



NA-14

Stand & Hand Mirrors made of Napure Mirror with Colored Frames STAND & HAND MIRROR

Product name	STAND & HAND Napure Mirror with COLORED FRAME(M)
Item Code.	NA-14
Suggested retail price	¥800 and tax
Size	135mm×220mm
Color	Pink / Blue / Clear
JAN	[Pink]240255 [Blue]240262 [Clear]240279
Quantity per carton	120
Material	[Frame]AS resin [Mirror]Napure Mirror



NA-30

Double-sided Stand & Hand Mirrors with Magnification & Plain Mirrors made of Napure Mirror MAGNIFICATION STAND & HAND MIRROR

Product name	DOUBLE-SIDED STAND & HAND MIRROR with 2x MAGNIFICATION & PLAIN Napure Mirrors
Item Code.	NA-30
Suggested retail price	¥3,200 and tax
Size	165mm×265mm
Color	Silver / Black
JAN	[Silver]772268 [Black]772275
Quantity per carton	60
Material	[Frame]PS resin [Mirror]Napure Mirror



MAGNIFICATION ②

*The 2x magnification mirror is made of a concave Napure Mirror having the radius of curvature (R) of 1000.

[Precaution for use]The magnification mirrors may focus the sun's rays to burn up a combustible material and cause fire. So do not use or store the magnification mirrors under direct sunlight. *At first, move your face close to the magnification mirror and then move away from the mirror to find the focal point you can see clearly reflected image. *Do not look at the magnified image too long. It may cause eyestrain or make you feel sick.

*Do not give impact to the mirrors by dropping off, etc. Impacted mirrors may break and hurt the user. *The metal parts of the mirrors are deteriorated when stored at high temperature and humidity for a long time. *Chemicals sticking on the mirrors must be wiped off with dry cloth.

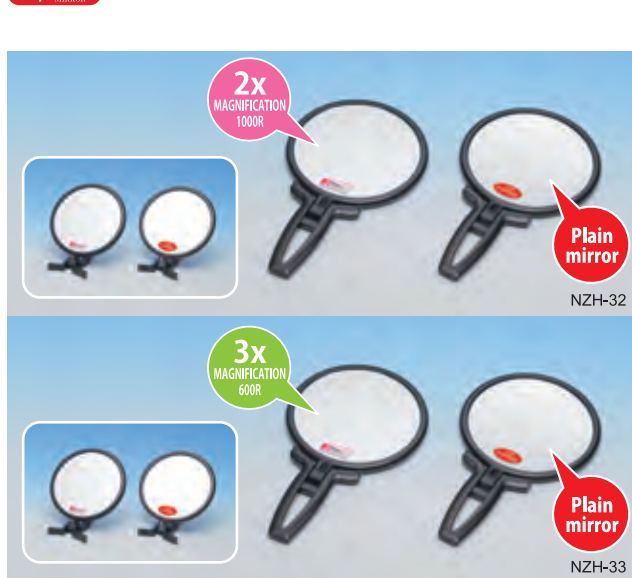

NZH-32

NZH-33

Stand & Hand Mirrors with Magnification & Plain Mirrors made of Napure Mirror MAGNIFICATION STAND & HAND MIRROR

Product name	DOUBLE-SIDED STAND & HAND MIRROR with 2x/3x MAGNIFICATION & PLAIN Napure Mirrors
Item Code.	(2x)NZH-32 (3x)NZH-33
Suggested retail price	(2x)¥1,600 and tax (3x)¥1,700 and tax
Size	123mm×210mm
Color	Black
JAN	[2x]772527 [3x]772534
Quantity per carton	120
Material	[Frame]ABS resin [Mirror]Napure Mirror



MAGNIFICATION ②③

*The 2x magnification and 3x magnification mirrors are made of concave Napure Mirrors having the radiuses of curvature (R) of 1000 and 600 respectively.

*Each of the "JAN codes" given in six digits in this catalogue constitutes the product code and check digit, and follows the code, 4510510 indicating the country and manufacturer codes.

The patented Napure Mirror (Japanese Patent No. 3732490)

Napure Mirror, Gloss and reflection proved by the patent

A high-class mirror more excellent than others to reflect the real color of your skin as seen by others

High Class Mirror

Napure Mirror



EL-02

3-WAY COMPACT Napure Mirror

Vertical setting For eye-make-up mirror

Usage of eye-make-up mirror

- 1 Open the mirror as illustrated on the right and set the top mirror surface opposite to the bottom mirror surface.
- 2 Move your face close to the mirrors and look into the mirrors.
- 3 The top mirror reflects your "upturned eyes".
Convenient for drawing eye lines on the rim of eyelids.
- 4 The bottom mirror reflects your "downcast eyes".
Convenient for checking the adhesion of false eyelashes and the eye lines already drawn.

★ Adjust the slant of the mirrors according to your use.



Horizontal setting For triple mirror

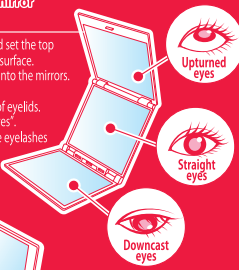

Good for your eye makeup! 3-WAY COMPACT Napure Mirror

napure MIRROR Triple-sided Mirror

品名	Item Code.	Suggested retail price	Size	Color	JAN	Quantity per carton	Material
3-WAY COMPACT Napure	EL-02	¥1,200 and tax	[Net weight] 88mm×95mm×10mm [Gross weight] 90mm×122mm×12mm [Weight] 100g(Net weight) / 105g(Gross weight)	Black	773029	120	[Frame] ABS resin [Mirror] Napure Mirror

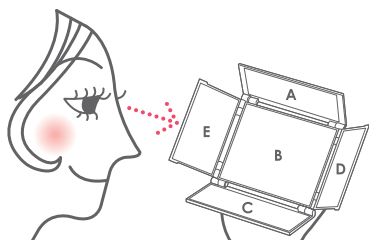

Looking into the mirror, you can check the five aspects of your eyes, upturned eyes, straight eyes, downcast eyes, and eyes viewed from the right and left sides, most of which you cannot check in a single mirror. The mirror will offer more enjoyable makeup to you.

A	B	C	D	E
upturned eyes	straight eyes	downcast eyes	right	left

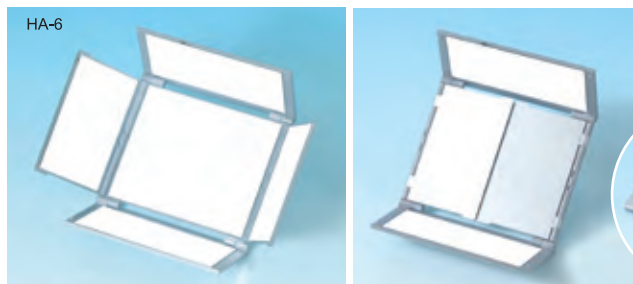

HA-6

Five-sided Compact Mirror made of Napure Mirror ALL-AROUND MIRROR

Product name	ALL-AROUND Napure Mirror (Five-sided Mirror)
Item Code.	HA-6
Suggested retail price	¥2,000 and tax
Size	115mm×95mm
Color	Metallic silver
JAN	240798
Quantity per carton	72
Material	[Frame] ABS resin [Mirror] Napure Mirror

napure MIRROR Five-sided Mirror

*Do not give impact to the mirrors by dropping off, etc. Impacted mirrors may break and hurt the user. *The metal parts of the mirrors are deteriorated when stored at high temperature and humidity for a long time. *Chemicals sticking on the mirrors must be wiped off with dry cloth.

*Each of the "JAN codes" given in six digits in this catalogue constitutes the product code and check digit, and follows the code, 4510510 indicating the country and manufacturer codes.

Professional Model for More Enjoyable Makeup

★ EYE MAKEUP MIRROR enables you to check your eye makeup from the directions unable to see in a single mirror ★
Triple, quadruple and five-sided compact mirrors convenient for carrying



EYE MAKE

×3 with 3x magnification mirror

3The magnification mirror added to the three slanted mirrors for checking eye makeup

Eyelash 4way Mirror Compact quadruple eye-makeup mirror

1 The magnification mirror added to the three slanted mirrors for checking eye makeup

The magnification mirror added to the three slanted mirrors for checking eye makeup

For checking your eye makeup perfectly!

Aren't you concerned about how your eye makeup looks when you are on the way to work or having a date? The mirror assures perfect checking of your eye makeup even to the rim of your upper eyelids you cannot directly see. You can quickly check your eye makeup from three different directions to finish your eye makeup so sophisticated and fine.

Usage

- 1 Open the mirror as illustrated on the right and set the top mirror surface opposite to the bottom mirror surface.
 - 2 Move your face close to the mirrors and look into the mirrors.
 - 3 The top mirror reflects your "upturned eyes". Convenient for drawing eye lines on the rim of eyelids.
 - 4 The bottom mirror reflects your "downcast eyes". Convenient for checking the adhesion of false eyelashes and the eye lines already drawn.
 - 5 Finally you can check your eye makeup with the 3x magnification mirror. Convenient for checking the stain or failure of eye makeup with the magnified image.
- ★Adjust the slant of the mirrors according to your use.



Check your eye makeup! Others may look at your eyes.

Points to be checked for fine eye makeup

- ★Are the false eyelashes attached tidily?
- ★Aren't the false eyelashes attached on a wrong position?
- ★Aren't your eyelids smudged with the mascara?
- ★Is the eye line drawn clearly?
- ★Is the eye shadow finely gradated?

3x Magnification mirror
Plain mirror

[Frame]ABS resin
[Mirror] 1-mm thick plain mirror,
1.3-mm thick 3x magnification mirror
with the radius of curvature (R) of 600

Compact quadruple eye-makeup mirror EYELASH 4-WAY MIRROR

Product name	Item Code.	Suggested retail price	Size	Color	JAN	Quantity per carton	Material
EYELASH 4-WAY MIRROR	EL-01	¥1,300 and tax Suggested retail price	[Product] 100mm×55mm×12mm [Package]55mm×125mm×14mm [Weight]80g(Net weight) / 83g(Gross weight)	Black	772992	120	[Frame]ABS resin [Mirror]glass mirror

Quadruple Mirror The 3x magnification mirror is made of a concave mirror having the radius of curvature (R) of 600.
[Precaution for use]The magnification mirrors may focus the sun's rays to burn up a combustible material and cause fire. So do not use or store the magnification mirrors under direct sunlight. *At first, move your face close to the magnification mirror and then move away from the mirror to find the focal point you can see clearly reflected image. *Do not look at the magnified image too long. It may cause eyestrain or make you feel sick.

*Do not give impact to the mirrors by dropping off, etc. Impacted mirrors may break and hurt the user. *The metal parts of the mirrors are deteriorated when stored at high temperature and humidity for a long time. *Chemicals sticking on the mirrors must be wiped off with dry cloth.

*Each of the "JAN codes" given in six digits in this catalogue constitutes the product code and check digit, and follows the code, 4510510 indicating the country and manufacturer codes.

Professional Model for More Enjoyable Makeup

EYE MAKEUP MIRROR enables you to check your eye makeup from the directions unable to see in a single mirror

Triple, quadruple and five-sided compact mirrors convenient for carrying

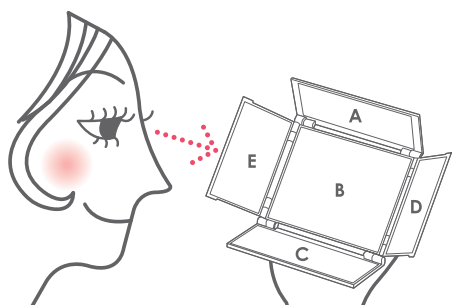

Looking into the mirror, you can check the five aspects of your eyes, upturned eyes, straight eyes, downcast eyes, and eyes viewed from the right and left sides, most of which you cannot check in a single mirror. The mirror will offer more enjoyable makeup to you.

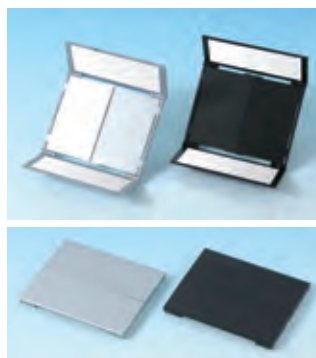
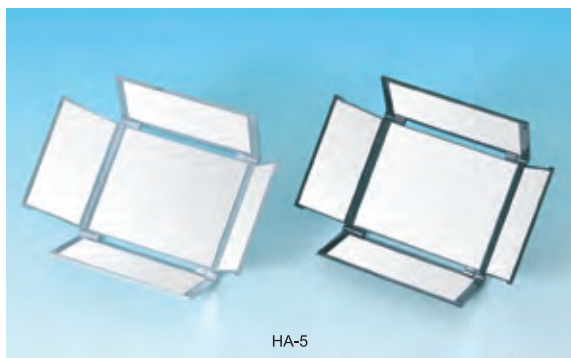

Five-sided Compact Mirrors ALL-AROUND MIRROR

Product name	ALL-AROUND MIRROR (Five-sided Mirror)
Item Code	HA-5
Suggested retail price	¥1,500 and tax
Size	115mm×95mm
Color	Metallic silver / Metallic black [Metallic silver] 771513
JAN	[Metallic black] 771520
Quantity per carton	72
Material	[Frame] ABS resin [Mirror] five-sided glass mirror

Five-sided Mirror

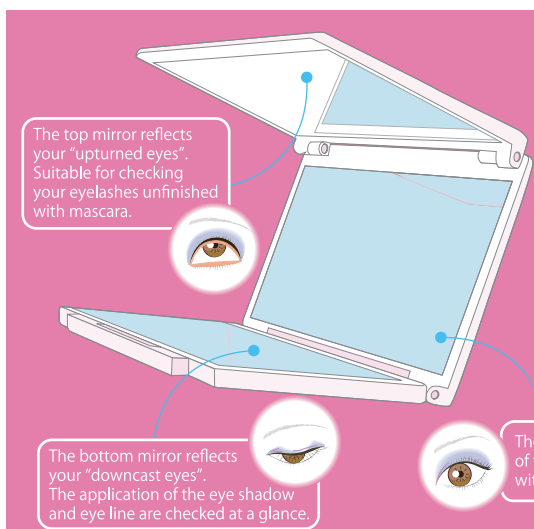

Quickly check your eye makeup you cannot watch in a single mirror. The mirror supports easy and comfortable eye makeup by showing your upturned eyes, straight eyes and downcast eyes.

Usually you can only check your eye makeup by watching your straight eyes in a single mirror.

The mirror can be opened and set to the slant suitable for your eye makeup, and enables the checking of your upturned eyes, straight eyes and downcast eyes at once.

The triple mirror for eye makeup gives you a comfortable and fulfilled makeup which is often difficult in a busy morning.

Patented

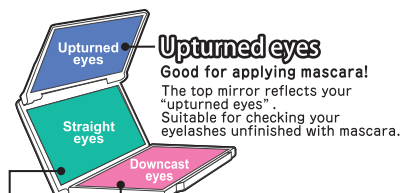
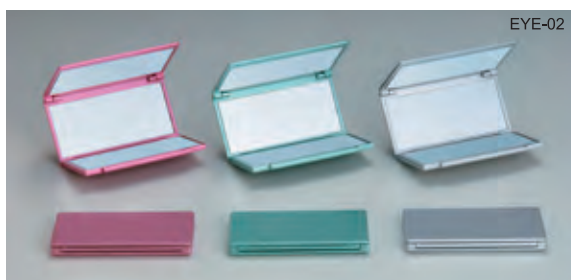

Eye Makeup Mirrors with Metallic Colored Frames EYE MAKEUP MIRROR

Product name	Item Code	Suggested retail price	Size	Color	JAN	Quantity per carton	Material
EYE MAKEUP MIRROR	EYE-02	¥1,100 and tax	100mm×55mm×10mm	Metallic silver	629319	180	[Frame] ABS resin
				Metallic blue	629326		[Mirror] glass mirror
				Metallic red	629333		

Triple-sided Mirror

*Do not give impact to the mirrors by dropping off, etc. Impacted mirrors may break and hurt the user. *The metal parts of the mirrors are deteriorated when stored at high temperature and humidity for a long time. *Chemicals sticking on the mirrors must be wiped off with dry cloth.

*Each of the "JAN codes" given in six digits in this catalogue constitutes the product code and check digit, and follows the code, 4510510 indicating the country and manufacturer codes.

Small size convenient for carrying

UV-detection Mirrors, the must for the season of strong UV radiation

Detecting UV radiation, the frame changes its color!

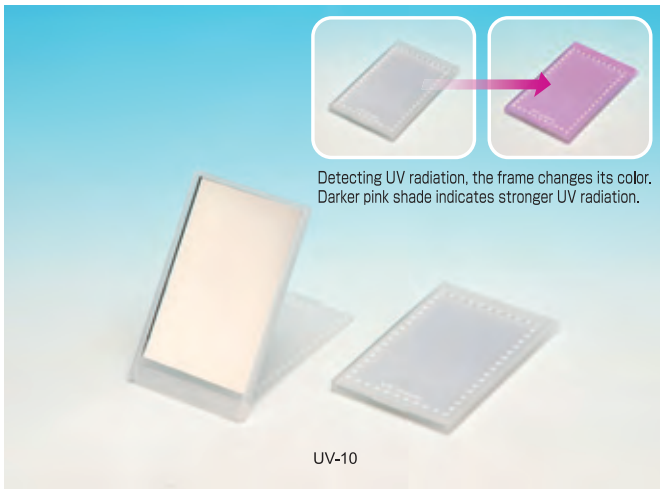

UV-detection Compact Mirror, Mini, Convenient for carrying

UV-DETECTION COMPACT MIRROR

Product name	UV-detection Compact Mirror, Mini
Item Code.	UV-10
Suggested retail price	¥400 and tax
Size	[Product]53mm×85mm×5.5mm
	[Package]56mm×117mm×8mm
	[Weight]26g(Net weight) 29g(Gross weight)
Color	White
JAN	773067
Quantity per carton	288
Material	[Frame]PP resin [Mirror]glass mirror



UV-detection Strapped Mirror, for anywhere any time

UV-DETECTION STRAPPED MIRROR

Product name	UV-DETECTION STRAPPED MIRROR (Round) (Square)
Item Code.	(Round) UV-008 (Square)UV-009
Suggested retail price	(Round) (Square)¥300 and tax
Size	(Round)28mm×45mm (Square)30mm×35mm
Color	White
JAN	[Round]771841 [Square]771858
Quantity per carton	300
Material	[Frame]PP resin [Mirror]glass mirror

For sales promotion items

Detecting UV radiation, the frame changes its color. Darker pink shade indicates stronger UV radiation.

low → very high

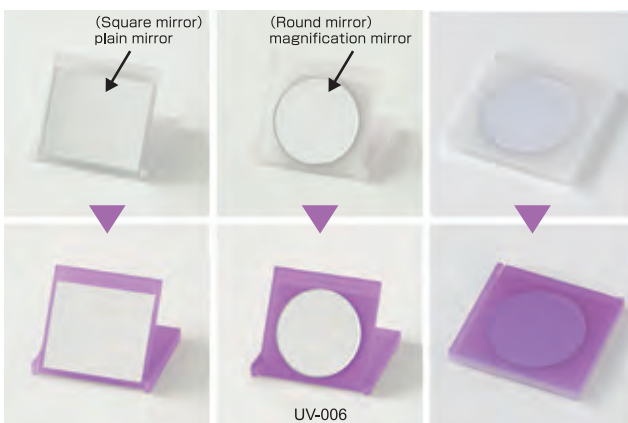

2-WAY UV-detection Mirror with magnification mirror

2-WAY UV-DETECTION MIRROR

Product name	2-WAY UV-DETECTION MIRROR	MAGNIFICATION ②
Item Code.	UV-006	For sales promotion items
Suggested retail price	¥600 and tax	
Size	80mm×71mm	
Color	White	
JAN	772916	
Quantity per carton	120	
Material	[Frame]PP resin [Mirror]glass mirror	

*Round mirror: 57-mm-diameter magnification mirror. Square mirror: 67 mm x 57 mm plain mirror
*The 2x magnification mirror is made of a concave mirror having the radius of curvature (R) of 1000.

[Precaution for use]The magnification mirrors may focus the sun's rays to burn up a combustible material and cause fire. So do not use or store the magnification mirrors under direct sunlight. *At first, move your face close to the magnification mirror and then move away from the mirror to find the focal point you can see clearly reflected image. *Do not look at the magnified image too long. It may cause eyestrain or make you feel sick.

*Although the frames of the products contain UV-sensitive pigments, the products are not designed to measure UV radiation. Their UV-sensitivity is not permanent and decreases after a long time exposure to UV radiation.

*Do not give impact to the mirrors by dropping off, etc. Impacted mirrors may break and hurt the user. *The metal parts of the mirrors are deteriorated when stored at high temperature and humidity for a long time. *Chemicals sticking on the mirrors must be wiped off with dry cloth.

*Each of the "JAN codes" given in six digits in this catalogue constitutes the product code and check digit, and follows the code, 4510510 indicating the country and manufacturer codes.

Small size convenient for carrying

UV-detection Mirrors, the must for the season of strong UV radiation

Detecting UV radiation, the frame changes its color!



the "Must" for the season of strong UV radiation

Good for sales promotion items with company or product names replacing the pattern of the sun

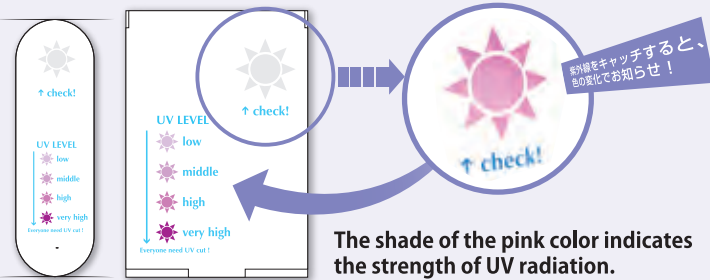

Charm Mirror

Compact mirror

UV-indication Mirrors, the must for the season of strong UV radiation

UV-INDICATION MIRROR

Product name	UV-INDICATION COMPACT MIRROR	UV-INDICATION CHARM MIRROR
Item Code.	UV-003	UV-004
Suggested retail price	¥500 and tax	¥400 and tax
Size	70mm×95mm	28mm×90mm
Color	White	White
JAN	240606	240613
Quantity per carton	288	600
Material	[Frame]PP resin & PS resin [Mirror]glass mirror	[Frame]PP resin [Mirror]glass mirror

*The charm mirror includes the attached ball chain and a case.

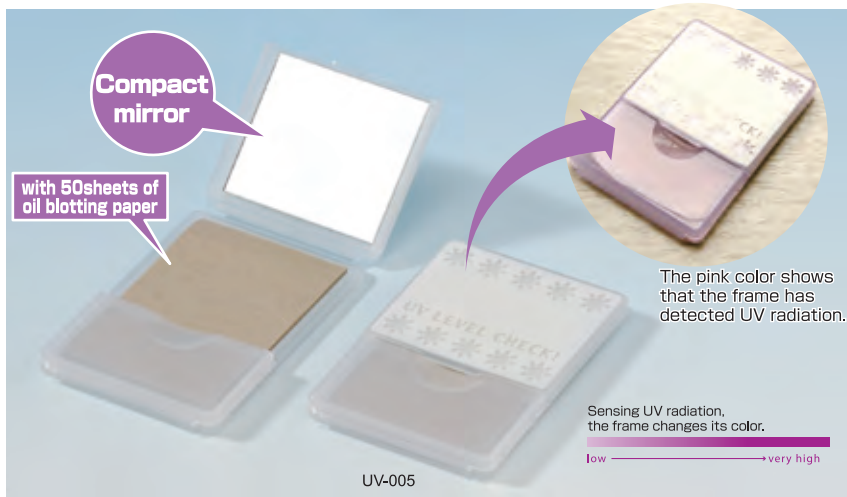

UV-indication Mirror with oil blotting paper

UV-INDICATION MIRROR

Product name	UV-INDICATION MIRROR with oil blotting paper
Item Code.	UV-005
Suggested retail price	¥450 and tax
Size	70mm×100mm
Color	Milky white
JAN	240705
Quantity per carton	288
Material	[Frame] PP resin [Mirror]glass mirror

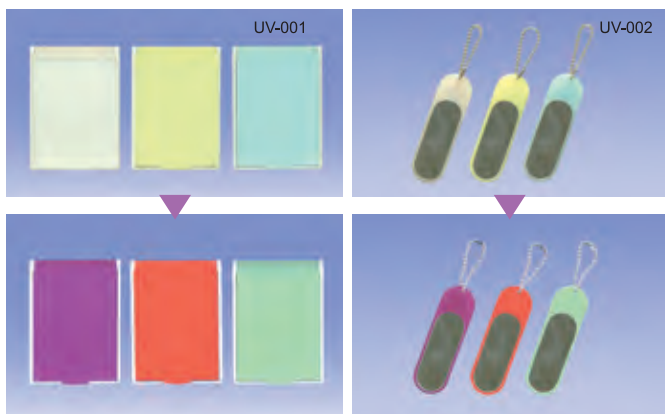

UV-detection Mirrors, the must for the season of strong UV radiation

UV-DETECTION MIRROR

Product name	UV-INDICATION COMPACT MIRROR	UV-DETECTION CHARM MIRROR
Item Code.	UV-001	UV-002
Suggested retail price	¥350 and tax	¥280 and tax
Size	70mm×95mm	28mm×90mm
Color	Clear / Yellow / Blue	Clear / Yellow / Blue
JAN	[Clear]228314 [Yellow]228321 [Blue]228338	[Clear]229342 [Yellow]229359 [Blue]229366
Quantity per carton	288	600
Material	[Frame]PP resin & PS resin [Mirror]glass mirror	[Frame]PP resin [Mirror]glass mirror



*The charm mirror includes the attached ball chain and a case.
*Color change: from clear to purple, from yellow to orange and from blue to green

*Although the frames of the products contain UV-sensitive pigments, the products are not designed to measure UV radiation. Their UV-sensitivity is not permanent and decreases after a long time exposure to UV radiation.

*Do not give impact to the mirrors by dropping off, etc. Impacted mirrors may break and hurt the user. *The metal parts of the mirrors are deteriorated when stored at high temperature and humidity for a long time. *Chemicals sticking on the mirrors must be wiped off with dry cloth.

*Each of the "JAN codes" given in six digits in this catalogue constitutes the product code and check digit, and follows the code, 4510510 indicating the country and manufacturer codes.

NEW

Good for earthquake countermeasures

Safe and secure plastic mirrors for effective use of the spaces of homes, offices and shops

SPACE MIRROR Large size

Safe and secure Break-proof mirror

Attached with 6 pieces of highly adhesive double-sided tape on the back of the mirror

1 POINT

Break-proof

The impact-resistant PET resin makes the mirrors break-proof and safe. Good for earthquake countermeasures.

2 POINT

Lightweight

The mirrors weigh less than half the weight of usual glass mirrors, and can be attached easily on various surfaces.

3 POINT

Scratch-resistant

The mirror is scratch-proof with the hardcoat and can be cleaned by the usual way for glass mirrors, such as wiping with cloth.

4 POINT

Easy installation

The mirrors can be attached on a smooth surface with the highly adhesive double-sided tapes. The tape secures the attachment.



Applicable to various uses! The space will be used for various purposes with your idea.



Installation *Peel off the protective film on the surface of the mirror.

- Wipe off the stain, dust and moisture on the surface where the mirror is attached. Then dry the surface enough.
- Peel off the release paper on the six pieces of the double-sided tape on the back of the mirror.
- Set the mirror on the surface and press the parts of the mirror having the double-sided tape on their back by sliding a balled-up tissue.

Surfaces for installation

- Surfaces where the double-sided tape can be attached.

Precautions for use *The highly adhesive tape may remain on the surface or give damage to wall paper after detaching the mirror.

- The hardcoated mirror surface can be damaged by hard materials such as wire wool.
 - Do not contact the mirror with organic solvents such as benzene and paint thinners.
 - Acidic or alkaline chemicals, such as mold removers and bleaches deteriorate or tarnish the mirror. When the mirror is stained with the chemicals, immediately wipe them off.
 - Wipe off the stain on the mirror lightly with cloth moistened with a mild detergent.
 - Be careful not to injure your hands at the edges of the mirror while cleaning the mirror.
 - Do not expose the mirror to high temperature above 70 °C that causes the deformation of the mirror.
 - For detaching the mirror from the surface, slowly remove the mirror without injuring your hands at the edges of the mirror.
- The highly adhesive tape may remain on the surface or give damage to wall paper after detaching the mirror.

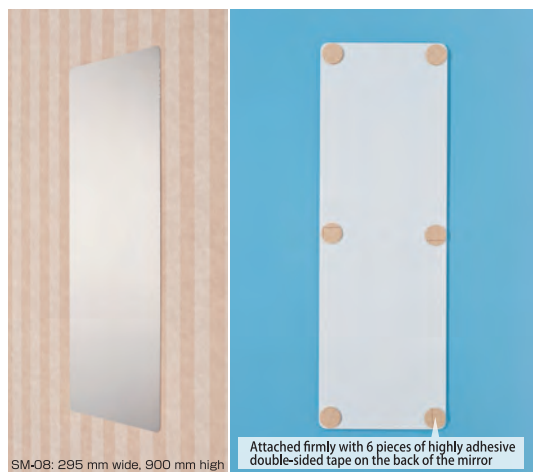

SPACE MIRROR Large size

Product name	SPACE MIRROR Large size	Item Code.	SM-08	Suggested retail price	¥12,000 and tax
JAN	773319	Quantity	6		
Size	[Mirror] 295mm×900mm×5mm [Package] 310mm×910mm×30mm [Weight] 1050g(Net weight) / 1600g(Gross weight)				

*The specification and suggested retail price may be changed.

*The mirror is designed to be permanently fixed on a surface with the highly adhesive tape, and cannot be repeatedly attached and detached, being different from the previous SPACE MIRRORS.

■ Cross section of the mirror

■ Material

- PET film mirror (with vapor-deposited aluminum layer)
- Impact-resistant styrol resin
- 3.0-mm thick aluminum-resin laminate (foamed resin sandwiched between aluminum layers)
- Highly adhesive double-sided tape, 4.7-mm diameter pieces set on 6 points

Repeatedly attachable and detachable mirror like a reusable sticker

Safe and secure, break-proof Space Mirror

Safe and secure plastic mirrors for effective use of the spaces of homes, offices and shops

SPACE MIRROR

Safe and secure Break-proof Mirror

Safe and secure plastic mirrors for effective use of spaces of homes, offices and shops





At the entrance



In the kitchen



For children's room



For offices



For shops

Break-proof & lightweight

The impact-resistant PET resin makes the mirrors break-proof and safe. The weight is less than the half of commonly-used mirrors.

Easy installation

The mirrors can be attached with the adhesive tape which is repeatedly attached and detached on a smooth surface.

Scratch-resistant

The mirror is scratch-proof with the hardcoat and can be cleaned by the usual way for glass mirrors, such as wiping with cloth.

attachable and detachable mirror like a reusable sticker

For attaching the mirror more firmly, use a commercially available double-sided tape.

Applicable to various uses! The space will be used for various purposes with your idea.

At home...

[Entrance]on the door, aluminum sash, shoe locker, walls, etc.
[Kitchen]on the refrigerator, cupboard, tile surface, wall, etc.
[Living and bed rooms]on the closet, cabinet, pillar, window, etc.

At offices...

On the door, aluminum sash, shoe locker, wall, steel furniture (lockers and cabinets)
For rearview mirrors at various sites including workshops, warehouses, etc.

At shops...

Bookstores, variety shops, clothing stores, accessory shops for looking glasses and preventing shoplifting

normal

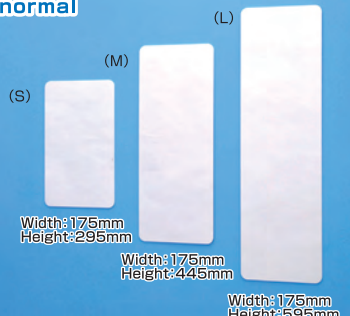

Width: 175mm
Height: 295mm

Width: 175mm
Height: 445mm

Width: 175mm
Height: 595mm

slim

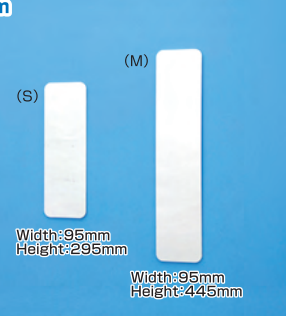

Width: 95mm
Height: 295mm

Width: 95mm
Height: 445mm

profiled



(Heart-shaped)
Width: 145mm
Height: 145mm

(Star-shaped)
Width: 145mm
Height: 145mm

Safe and Secure Plastic Mirrors **SPACE MIRROR** *The specification and suggested retail price may be changed.

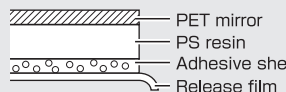

Product name	Item Code.	Suggested retail price	Size	JAN	Quantity per carton
SPACE MIRROR, normal (S)	SM-01	¥1,700 and tax	175mm×295mm	772374	48
(M)	SM-02	¥2,400 and tax	175mm×445mm	772381	36
(L)	SM-03	¥3,000 and tax	175mm×595mm	772398	24
SPACE MIRROR, slim (S)	SM-04	¥1,000 and tax	95mm×295mm	772404	72
(M)	SM-05	¥1,400 and tax	95mm×445mm	772411	60
SPACE MIRROR, profiled (Heart-shaped)	SM-06	¥1,000 and tax	145mm×145mm	772428	72
(Star-shaped)	SM-07	¥1,000 and tax	145mm×145mm	772435	72

■ Cross section of the mirror



■ Material
PET film mirror
PS resin
Acrylate adhesive sheet

Installation

-  Wipe off the stain, dust and moisture on the surface where the mirror is attached. Then dry the surface enough.
-  Peel off the transparent release film on the back of the mirror.
-  Set the mirror on the surface and press the mirror by sliding a balled-up tissue without injuring your hands at the edges of the mirror.

Surfaces for installation

The mirror can be attached on a flat wall surface without asperities, such as glass, tiles, coated metals, plastics, plywood, and gloss-coated wood. The mirror cannot be attached on rough surfaces.

Precautions for use

- The hardcoated mirror surface may be damaged by hard materials such as wire wool.
- Do not contact the mirror with organic solvents such as benzine and paint thinners.
- Acidic or alkaline chemicals, such as mold removers and bleaches deteriorate or tarnish the mirror. When the mirror is stained with the chemicals, immediately wipe them off.
- Wipe off the stain on the mirror lightly with cloth moistened with a mild detergent.
- Be careful not to injure your hands at the edges of the mirror while cleaning the mirror.
- Do not expose the mirror to high temperature above 70 °C that causes the deformation of the mirror.
- For detaching the mirror from the surface, slowly remove the mirror without injuring your hands at the edges of the mirror. If the adhesive tape remains on the surface, wipe off with wet cloth.
- The adhesion strength of the adhesive tape may be decreased when wet with water.

*Each of the "JAN codes" given in six digits in this catalogue constitutes the product code and check digit, and follows the code, 4510510 indicating the country and manufacturer codes.

NEW

PHOTO-DISPLAY MIRROR

We recommend the PHOTO DISPLAY MIRROR for the gift to your family members, colleagues and friends on their great occasion including graduation, retirement, etc. Your commemorative photos can be displayed in the mirror frame with impressive verses.



Congratulations on your graduation!

All Your dreams can come true,
if you have the courage to pursue them.
Even though we face the difficulties of today and tomorrow,
I still have a dream.
A problem is a chance for you to do your best.
Change before you have to.



For commemorating your graduation, leave from clubs and group activities, attendance at competitions, anniversary days.....

Please refer to the instruction manual for lettering your photos.

Steps for displaying a photo

1 Print a photo

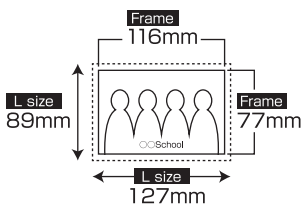

Arrange the letters within the frame (77 mm x 116 mm).

Print the photo into 89 mm x 127 mm.

2 Attach the photo on the transparent part of the mirror plate.

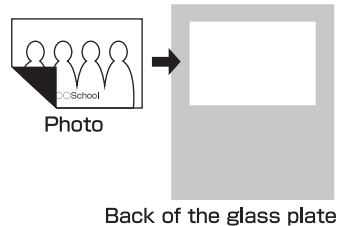

Attach the photo on the back of the mirror plate to fit the transparent part with the provided sticker.

3 Fix the back plate on the back of the mirror plate.

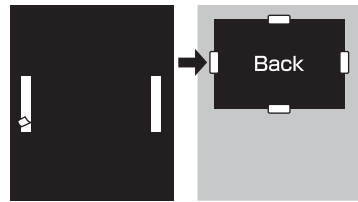

back plate Back of the glass plate Peel off the release paper of the double-sided tapes on the back plate, and attach the back plate on the back of the mirror plate.

If you plan to change the photo in the future, do not attach the back plate with the double-sided tapes.

4 Finally fix the finished photo-display mirror on the stand.



PHOTO-DISPLAY MIRROR made in Japan

Product name	Item Code	Suggested retail price	Size	JAN	Quantity per carton	Material
PHOTO-DISPLAY MIRROR	MP-01	¥1,700 and tax	[Product] 150mm×180mm×25mm [Package] 175mm×190mm×36mm [Weight] 280g(Net weight) / 340g(Gross weight)	773555	48	[Parts] Mirror plate, back plate (PS resin), stand (PS resin)

- [Contents in the package]**
- Stand x1
 - Back plate x1
 - Four stickers to attach a photo x4
 - Instruction manual x1



PHOTO-DISPLAY MIRROR without verses for versatile use

*Do not give impact to the mirrors by dropping off, etc. Impacted mirrors may break and hurt the user. *The metal parts of the mirrors are deteriorated when stored at high temperature and humidity for a long time. *Chemicals sticking on the mirrors must be wiped off with dry cloth.

*Each of the "JAN codes" given in six digits in this catalogue constitutes the product code and check digit, and follows the code, 4510510 indicating the country and manufacturer codes.

Mirrors for more enjoyable makeup

Stain-resistant mirror protected by high water-repellency

Easy care! Ever-clear mirror for makeup!



- COMPACT
- STAND & HAND
- PROFESSIONAL MODEL

The high water repellency of the mirror always protects the mirror from stain.

Testing with an aqueous marker pen (in our test)

EVER-CLEAR MIRROR repels the ink of the marker pen.

EVER-CLEAR MIRROR

Testing with an aqueous marker pen (in our test)

The conventional mirror is considerably stained by the marker pen.

Conventional mirror

What's "EVER-CLEAR MIRROR"?
 "EVER-CLEAR MIRROR" is manufactured by coating a mirror with high-performance durable water repellent. The coating makes mirror surface stain-resistant, and stain on the mirror surface is easily removable.
 The easy-care mirror is always clear and helps your makeup.



SLIM & LIGHT COMPACT MIRROR



STAND & HAND MIRROR



PROFESSIONAL MODEL MIRROR

Three types of EVER-CLEAR MIRRORS with excellent performance

EVER-CLEAR MIRROR SLIM & LIGHT COMPACT MIRROR / STAND & HAND MIRROR / PROFESSIONAL MODEL MIRROR

Product name	Item Code.	Suggested retail price	Size	Color	JAN	Quantity per carton	Material
EVER-CLEAR SLIM & LIGHT COMPACT MIRROR (M)	HV-001	¥800 and tax	104mm×130mm×4.5mm	White	771889	180	[Frame]ABS resin [Mirror]glass mirror
				Black	771896		
EVER-CLEAR SLIM & LIGHT COMPACT MIRROR (L)	HV-002	¥1,000 and tax	124mm×160mm×4.5mm	White	771902	120	[Frame]PS resin [Mirror]glass mirror
				Black	771919		
EVER-CLEAR STAND & HAND MIRROR	HV-003	¥900 and tax	127mm×213mm	White	771926	120	[Frame]PS resin [Mirror]glass mirror
				Black	771933		
PROFESSIONAL MODEL EVER-CLEAR FOLDABLE STAND MIRROR (M)	HV-004	¥1,200 and tax	125mm×175mm	White	771940	120	[Frame]EVA resin [Mirror]glass mirror
				Black	771957		
PROFESSIONAL MODEL EVER-CLEAR FOLDABLE STAND MIRROR (L)	HV-005	¥2,000 and tax	175mm×225mm	White	771964	60	[Frame]EVA resin [Mirror]glass mirror
				Black	771971		

Ultraslim & Ultralight **eco** Slant adjustable to three positions

*Do not give impact to the mirrors by dropping off, etc. Impacted mirrors may break and hurt the user. *The metal parts of the mirrors are deteriorated when stored at high temperature and humidity for a long time. *Chemicals sticking on the mirrors must be wiped off with dry cloth.

*Each of the "JAN codes" given in six digits in this catalogue constitutes the product code and check digit, and follows the code, 4510510 indicating the country and manufacturer codes.

Simple form fitting to various interior designs
Stand Mirror for complete makeup
 Wide surface convenient for makeup



TRIPLE TABLE MIRROR Standable Triple Mirror

The mirror clearly shows you the top of your head for caring and checking the parts you could not directly watch.

- For wearing and removing your wig, hairpiece and extension
- For checking undyed hair
- Horizontal setting for makeup

Shows the top of your head you cannot easily watch.

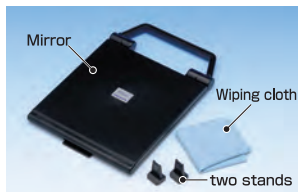

▲ Contents in the package ▲ Vertical setting ▲ Horizontal setting

TRIPLE TABLE MIRROR reflects the parts difficult to watch Standable Triple Mirror **TRIPLE TABLE MIRROR**

Product name	Item Code	Suggested retail price	Size	Color	JAN	Quantity per carton	Material
TRIPLE TABLE MIRROR Standable Triple Mirror	CM-01	¥8,300 and tax	20mm×230mm×350mm	Black	772343	10	[Frame]ABS resin [Mirror]glass mirror

Slant adjustable Triple mirror

*Contents in the package: Triple mirror, two stands, Instruction manual, Wiping cloth (microfiber cloth)

Simple form fitting to various interior designs
Stand Mirror for complete makeup
 Wide surface convenient for makeup



Simple stand mirror used anywhere, horizontally and vertically standable
HIGH-QUALITY STAND MIRROR

Product name	HIGH-QUALITY STAND MIRROR
Item Code	HQ-01
Suggested retail price	¥900 and tax
Size	[Frame] 152mm×207mm×20mm
	[Mirror] 152mm×202mm×5mm
	[Package] 165mm×220mm×28mm
	[Weight] 420g(Net weight) / 470g(Gross weight)
JAN	772985
Quantity per carton	36
Material	[Mirror] glass mirror [Stand] PS resin

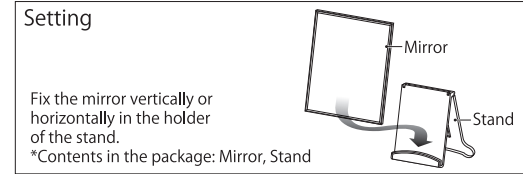

Stand mirror with simple form
SIMPLE STAND MIRROR

Product name	SIMPLE STAND MIRROR(M)
Item Code	SS-01
Suggested retail price	¥1,200 and tax
Size	198mm×242mm×25mm
Color	Black / Silver
JAN	[Black] 773203 [Silver] 773197
Quantity per carton	30
Material	[Frame] PS resin [Mirror] glass mirror

Slant adjustable



Stand mirror with a storage tray for accessories on the stand
STAND MIRROR

Product name	SHELDON DELUXE STAND MIRROR
Item Code	H-318
Suggested retail price	¥1,400 and tax
Size	193mm×247mm×74mm
Color	Black
JAN	771865
Quantity per carton	24
Material	[Frame] PS resin [Mirror] glass mirror

Slant adjustable



Simple Wooden-framed Stand Mirror
STAND MIRROR

Product name	WOODEN-FRAMED STAND MIRROR (M)	WOODEN-FRAMED STAND MIRROR (L)
Item Code	MS-01	MS-02
Suggested retail price	¥1,200 and tax	¥1,500 and tax
Size	150mm×200mm	175mm×250mm
Color	Silver / Wood grain	Silver / Wood grain
JAN	[Silver] 773159	[Silver] 773173
	[Wood grain] 773166	[Wood grain] 773180
Quantity per carton	48	36
Material	[Frame] MDF (medium density fiberboard)	[Frame] MDF (medium density fiberboard)
	[Mirror] glass mirror	[Mirror] glass mirror

Slant adjustable

*Do not give impact to the mirrors by dropping off, etc. Impacted mirrors may break and hurt the user. *The metal parts of the mirrors are deteriorated when stored at high temperature and humidity for a long time. *Chemicals sticking on the mirrors must be wiped off with dry cloth.

*Each of the "JAN codes" given in six digits in this catalogue constitutes the product code and check digit, and follows the code, 4510510 indicating the country and manufacturer codes.

Simple form fitting to various interior designs
Stand Mirror for complete makeup
 Wide surface convenient for makeup



STAND



Stand Mirrors with the frame and stand made of MDF
STAND MIRROR

Product name	WOODEN-FRAMED STAND MIRROR : WOODEN-FRAMED STAND MIRROR	
Item Code.	H-300(Black/Wood grain)	H-301 (Black/Wood grain)
Suggested retail price	¥2,400 and tax	¥3,000 and tax
Size	252mm×245mm×78mm	302mm×290mm×78mm
Color	Black / Wood grain	Black / Wood grain
JAN	[Black]300126 [Wood grain]300133	[Black]301123 [Wood grain]301130
Quantity per carton	20	16
Material	[Frame]MDF (medium density fiberboard) [Mirror]glass mirror	

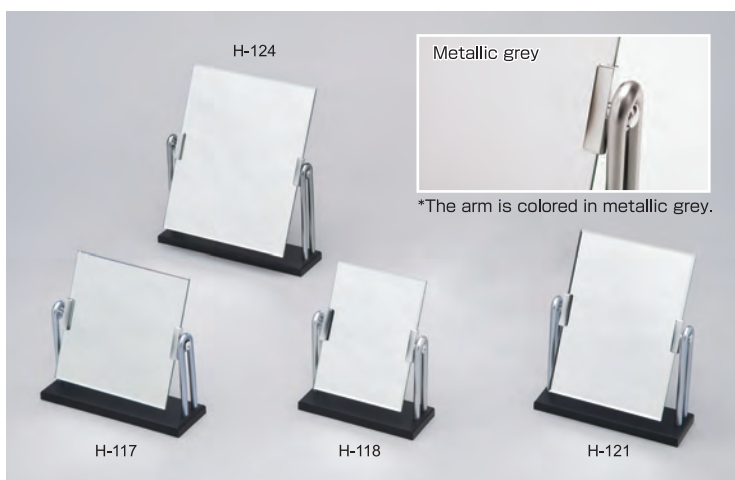

Stand mirror with the black MDF stand and 5-mm thick luxurious beveled mirror
STAND MIRROR

Product name	SHELDON DELUXE STAND MIRROR, Black stand series	
Item Code.	[H-117]¥1,800 and tax	252mm×240mm
Suggested retail price	[H-118]¥1,600 and tax	198mm×240mm
Size	[H-121]¥2,000 and tax	228mm×290mm
	[H-124]¥2,600 and tax	302mm×340mm
Color	Silver (arm)	
JAN	[H-117S]117014 (20)	[H-118S]118011 (24)
Quantity per carton	[H-121S]121011 (20)	[H-124S]124012 (14)
Material	[Stand]MDF (medium density fiberboard) [Mirror]glass mirror	

Slant adjustable *Depth: 78 mm (common to all of the items)

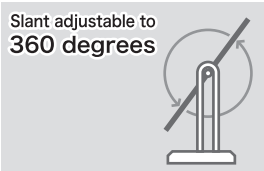

Slant adjustable to 360 degrees

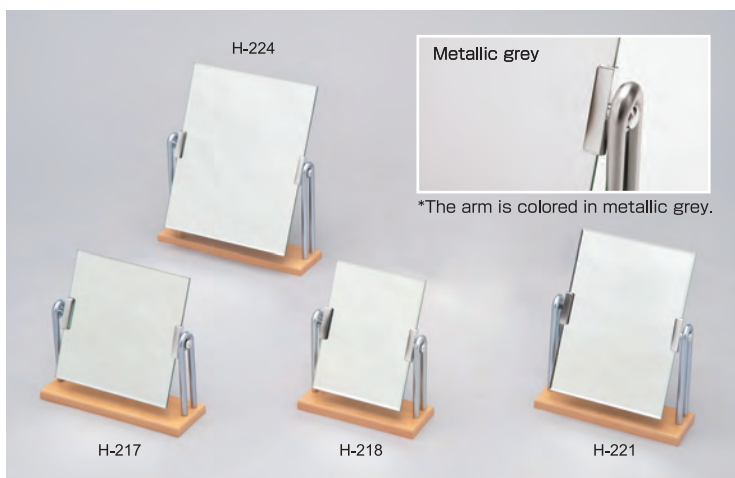

Stand mirror with the maple MDF stand and 5-mm thick luxurious beveled mirror
STAND MIRROR

Product name	SHELDON DELUXE STAND MIRROR, Woody stand series	
Item Code.	[H-217]¥1,800 and tax	252mm×240mm
Suggested retail price	[H-218]¥1,600 and tax	198mm×240mm
Size	[H-221]¥2,000 and tax	228mm×290mm
	[H-224]¥2,600 and tax	302mm×340mm
Color	Silver (arm)	
JAN	[H-217S]217011 (20)	[H-218S]218018(24)
Quantity per carton	[H-221S]221018(20)	[H-224S]224019 (14)
Material	[Stand]MDF (medium density fiberboard) [Mirror]glass mirror	

Slant adjustable *Depth: 78 mm (common to all of the items)

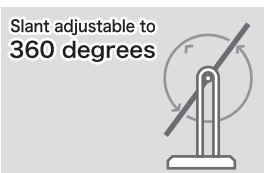

Slant adjustable to 360 degrees

*Do not give impact to the mirrors by dropping off, etc. Impacted mirrors may break and hurt the user. *The metal parts of the mirrors are deteriorated when stored at high temperature and humidity for a long time. *Chemicals sticking on the mirrors must be wiped off with dry cloth.

*Each of the "JAN codes" given in six digits in this catalogue constitutes the product code and check digit, and follows the code, 4510510 indicating the country and manufacturer codes.

Simple form
Very popular easy-to-carry compact mirror
 Small enough to put in your bag

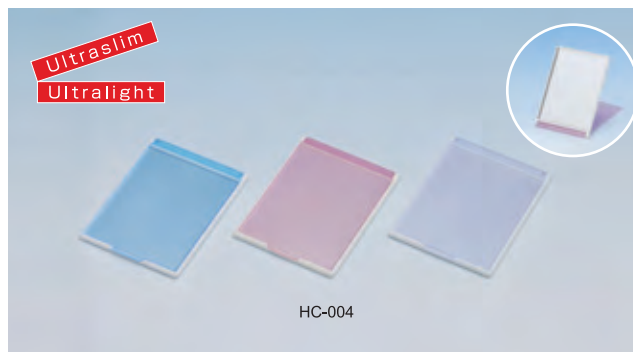

Slim and light small compact mirror
SLIM & LIGHT COMPACT MIRROR MINI

Product name	SLIM & LIGHT COMPACT MIRROR, MINI
Item Code.	HC-004
Suggested retail price	¥400 and tax
Size	70mm×95mm×4.5mm
Color	Blue / Pink / White
JAN	[Blue]918116 [Pink]918123 [White]918147
Quantity per carton	288
Material	[Frame]PS resin [Mirror]glass mirror

Ultralight & Ultralight

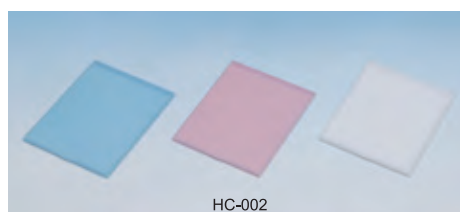

Slim & Light Compact Mirrors with frames in three pastel colors
SLIM & LIGHT COMPACT MIRROR

Product name	SLIM & LIGHT COMPACT MIRROR with Pastel-colored Frame (S)	SLIM & LIGHT COMPACT MIRROR with Pastel-colored Frame (M)	SLIM & LIGHT COMPACT MIRROR with Pastel-colored Frame (L)
Item Code.	HC-003	HC-001	HC-002
Suggested retail price	¥400 and tax	¥500 and tax	¥700 and tax
Size	95mm×103mm×4.5mm	104mm×130mm×4.5mm	124mm×160mm×4.5mm
Color	Blue / Pink / White	Blue / Pink / White	Blue / Pink / White
JAN	[Blue]003119	[Blue]001016	[Blue]002013
	[Pink]003126	[Pink]001023	[Pink]002020
	[White]003157	[White]001054	[White]002051
Quantity per carton	240	180	120
Material	[Frame]PS resin [Mirror]glass mirror		



Ultralight & Ultralight

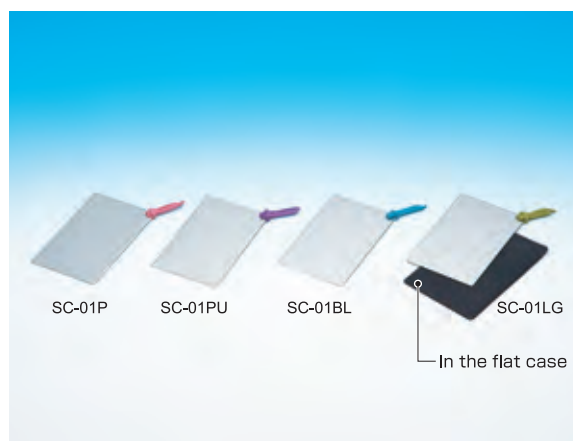

Break-proof Stainless Mirror, Easy-to-carry thin mirror in credit-card size
STAINLESS CARD MIRROR

Product name	STAINLESS CARD MIRROR (Pink) (Purple) (Blue) (Light green)
Item Code.	[Pink]SC-01P [Purple]SC-01PU [Blue]SC-01BL [Light green]SC-01LG
Suggested retail price	¥700 and tax
Size	[Mirror]54mm×85mm [Case]63mm×92mm
Color	Pink / Purple / Blue / Light green
JAN	[Pink]772824 [Purple]772831 [Blue]772848 [Light green]772855
Quantity per carton	120
Material	[Mirror]stainless [Strap]PU [Case]EVA resin

[Precautions for use] ●Do not bend the mirror. Bending make flexure on mirror surface. ●Do not rub the mirror surface with hard materials such as wire wool or sand paper which damage the surface. ●Use the mirror only for reflecting images. Do not use for other purposes. ●Wipe off the stain on the mirror with soft cloth.

*Do not give impact to the mirrors by dropping off, etc. Impacted mirrors may break and hurt the user. *The metal parts of the mirrors are deteriorated when stored at high temperature and humidity for a long time. *Chemicals sticking on the mirrors must be wiped off with dry cloth.

*Each of the "JAN codes" given in six digits in this catalogue constitutes the product code and check digit, and follows the code, 4510510 indicating the country and manufacturer codes.

NEW

The magnification mirror magnifies your face to the details and is suitable to care keratin plugs, mottles and wrinkles on your skin.

CLIP MIRROR 3x 5x

Add the magnification mirror for your makeup.

CLIP MIRROR 2type

3x and 5x magnification mirrors, now on sale!

Add the mirror to your daily-use mirror...



For base makeup...

The position of the clip mirror can be adjusted not to disturb your makeup.



For checking the detail of your makeup...

The mirror can be set at the position convenient for checking the detail of your makeup, such as eye makeup.



At the washstand...



Convenient for your makeup at the washstand



The photo shows an image of reflection in the magnification mirror.

The mirror can be tilted upward and downward.



The shaft can be turned upward and downward.



The mirror can be turned right and left.

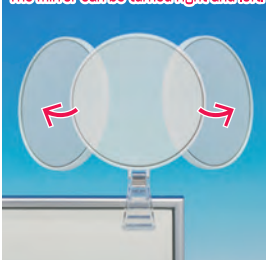

The clip can grip an edge having a thickness of 25 mm or less.



90-mm-diameter round mirror



Nonslip and nonabrasive Elastomer clip

Two variants of magnification, 3x and 5x

Reflected images in a plain mirror and magnification mirror



Plain mirror

3x

5x

Image of the curvature of the mirror



3X(600R)



5X(400R)

Usage and precautions for use

●At first, move your face close to the magnification mirror and then move away from the mirror to find the focal point you can see clearly reflected image. ●A mirror of greater curvature has shorter focal length, in other words, you can see a clear image nearer to the mirror surface. ●A high-magnification mirror gives vague image outside the focal point. ●Do not look at the magnified image too long. It may cause eyestrain or make you feel sick.

*Images are magnified in concave mirrors and enlarged more with the increase of their curvature. The magnification of our mirrors is roughly indicated by the radius of curvature (abbreviated as "R") of the mirrors. A magnification mirror having smaller radius of curvature (R) has greater curvature, in other words, reflects a larger image.

*The magnification mirrors may focus the sun's rays to burn up a combustible material and cause fire. So do not use or store the magnification mirrors under direct sunlight.

*Magnification mirror without a plain mirror.

ONE PLUS CLIP MIRROR 3x 5x

Product name	Item Code	Suggested retail price	Size	Color	JAN	Quantity per carton	Material
3x CLIP MIRROR	PC-03	¥1,300 and tax	[Product](Frame)95-mm-diameter round (Mirror)glass mirror:90-mm-diameter round mirror (Clip)length135mm,width25mm (Package)100mm×50mm×180mm(Package)	White	773562	72	Frame: ABS resin, Mirror: glass mirror Clip: ABS resin, polyacetal, polycarbonate, steel, elastomer Double-sided tape: polyurethane
5x CLIP MIRROR	PC-05	¥1,400 and tax	[Weight]61g(Net weight) / 97g(Gross weight)		773579		



Easy-to-carry Foldable and Standable Compact Magnification Mirrors
The magnification mirror magnifies your face to the details and is suitable to care keratin plugs, mottles and wrinkles on your skin.

PROFESSIONAL MODEL MAGNIFICATION MIRROR

3x
Concave mirror of 600R

HP-03F

For easy makeup! Slant adjustable to three positions

5x
Concave mirror of 400R

HP-05F

For easy makeup! Slant adjustable to three positions

3x
Concave mirror of 600R

HP-03M

For easy makeup! Slant adjustable to three positions

5x
Concave mirror of 400R

HP-05M

For easy makeup! Slant adjustable to three positions

3x
Concave mirror of 600R

HP-03D

For easy makeup! Slant adjustable to three positions

5x
Concave mirror of 400R

HP-05D

For easy makeup! Slant adjustable to three positions

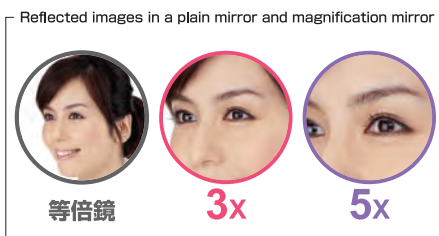

[Usage]

●At first, move your face close to the magnification mirror and then move away from the mirror to find the focal point you can see clearly reflected image. ●A mirror of greater curvature has shorter focal length, in other words, you can see a clear image nearer to the mirror surface. ●A high-magnification mirror gives vague image outside the focal point. ●Do not look at the magnified image too long. It may cause eyestrain or make you feel sick.

*Images are magnified in concave mirrors and enlarged more with the increase of their curvature. The magnification of our mirrors is roughly indicated by the radius of curvature (abbreviated as "R") of the mirrors. A magnification mirror having smaller radius of curvature (R) has greater curvature, in other words, reflects a larger image.

*The magnification mirrors may focus the sun's rays to burn up a combustible material and cause fire. So do not use or store the magnification mirrors under direct sunlight.

*Magnification mirror without a plain mirror.

PROFESSIONAL MODEL MAGNIFICATION MIRROR 3x 5x

Product name	Item Code.	Suggested retail price	Size	Pattern	JAN	Quantity per carton	Material
PROFESSIONAL MODEL MAGNIFICATION MIRROR 3x	[Floral pattern] HP-03F	¥1,500 and tax	[Product] 115mm×100mm×15mm [Package] 135mm×150mm×20mm [Weight] 78g(Net weight) / 83g(Gross weight)	Floral pattern	773494	72	[Frame]cotton fabric [Mirror]glass mirror *The 3x magnification and 5x magnification mirrors are made of concave mirrors having the radiuses of curvature (R) of 600 and 400 respectively.
	[Monochrome] HP-03M			Monochrome	773500		
	[Polka dot] HP-03D			Polka dot	773517		
PROFESSIONAL MODEL MAGNIFICATION MIRROR 5x	[Floral pattern] HP-05F	¥1,600 and tax		Floral pattern	773524	72	
	[Monochrome] HP-05M			Monochrome	773531		
	[Polka dot] HP-05D			Polka dot	773548		

Slant adjustable to three positions

*Do not give impact to the mirrors by dropping off, etc. Impacted mirrors may break and hurt the user. *The metal parts of the mirrors are deteriorated when stored at high temperature and humidity for a long time. *Chemicals sticking on the mirrors must be wiped off with dry cloth.

*Each of the "JAN codes" given in six digits in this catalogue constitutes the product code and check digit, and follows the code, 4510510 indicating the country and manufacturer codes.

Professional Model Foldable Stand Mirrors, Magnification Mirrors, Hand Mirrors

Other Mirrors

User-friendly & Simple Form

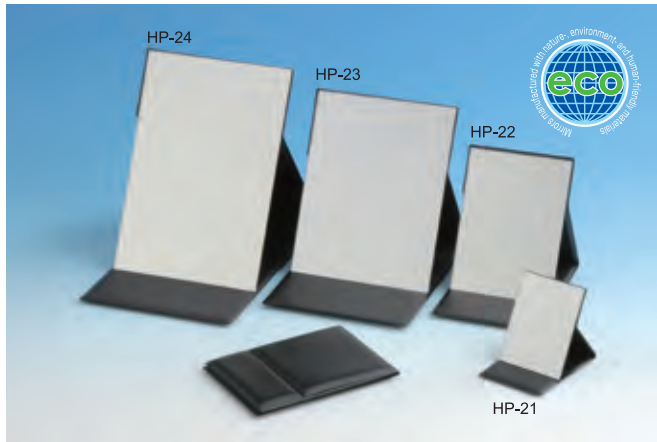

Eco-friendly Professional Model Foldable Stand Mirror PROFESSIONAL MODEL FOLDABLE STAND MIRROR **eco**

Product name	PROFESSIONAL MODEL FOLDABLE STAND MIRROR, ECO(S·M·L·LL)			
Item Code.	[S]HP-21	[M]HP-22	[L]HP-23	[LL]HP-24
Suggested retail price	[S]¥600 and tax [M]¥1,000 and tax			
	[L]¥1,600 and tax [LL]¥2,200 and tax			
Size	[S]80mm×110mm [M]125mm×175mm			
	[L]175mm×225mm [LL]185mm×280mm			
Color	black			
JAN	[S]240712	[M]240729	[L]240736	[LL]240743
Quantity per carton	[S]240	[M]120	[L]60	[LL]40
Material	[Frame]EVA resin [Mirror]glass mirror			



PROFESSIONAL MODEL



MAGNIFICATION



STAND&HAND



Magnification Compact Mirror with Cute Glittering Frame MAGNIFICATION COMPACT MIRROR

Product name	2x MAGNIFICATION COMPACT MIRROR	3x MAGNIFICATION COMPACT MIRROR
Item Code.	HZ-02	HZ-03
Suggested retail price	¥600 and tax	¥700 and tax
Size	97mm×106mm	97mm×106mm
Color	Pink	Pink
JAN	240149	240163
Quantity per carton	144	144
Material	[Frame]PS resin [Mirror]glass	[Frame]PS resin [Mirror]glass



*The 2x magnification and 3x magnification mirrors are made of concave mirrors having the radiuses of curvature (R) of 1000 and 600 respectively.

[Precaution for use] *The magnification mirrors may focus the sun's rays to burn up a combustible material and cause fire. So do not use or store the magnification mirrors under direct sunlight.*At first, move your face close to the magnification mirror and then move away from the mirror to find the focal point you can see clearly reflected image.*Do not look at the magnified image too long. It may cause eyestrain or make you feel sick.



Stand & Hand Mirrors with pastel-colored frames STAND & HAND MIRROR

Product name	STAND & HAND MIRROR with Pastel-colored Frame		
Item Code.	HS-001		
Suggested retail price	¥800 and tax		
Size	127mm×215mm		
Color	Blue / Pink / White		
JAN	[Blue] 101013	[Pink] 101020	[White] 101051
Quantity per carton	120		
Material	[Frame]PS resin [Mirror]glass mirror		

From Compact to Stand Mirrors
Various Forms and Sizes for Sales Promotion Items
 With Corporate or Product Logo!

SP向け

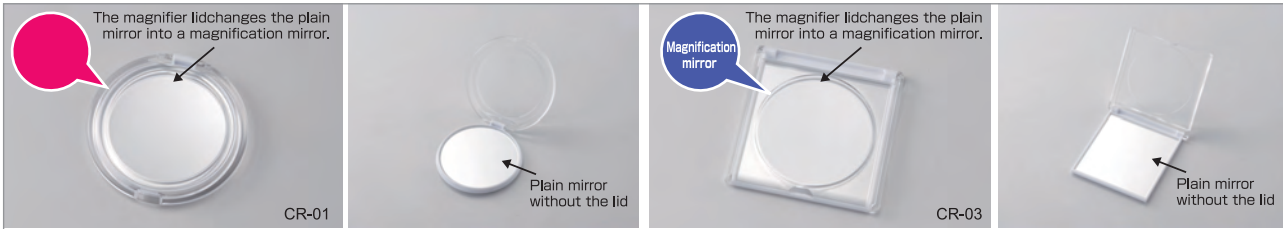

Compact Mirrors with Magnifier Lids, Convenient for Eye Makeup, Round and Square Forms, Images are Magnified by the Lid
CRYSTAL COMPACT MIRROR with Magnifier Lid

Product name	Item Code.	Size	Color	Material
CRYSTAL COMPACT MIRROR, round, with 5x Magnifier Lid	CR-01	85mm×8.7mm	clear	[Frame]PS resin, acrylate resin [Mirror]glass mirror
CRYSTAL COMPACT MIRROR, square, with Magnifier Lid	CR-03	81mm×81mm	clear	[Frame]PS resin, acrylate resin [Mirror]glass mirror

[Precaution for use] *The magnification mirrors may focus the sun's rays to burn up a combustible material and cause fire. So do not use or store the magnification mirrors under direct sunlight.*At first, move your face close to the magnification mirror and then move away from the mirror to find the focal point you can see clearly reflected image.*Do not look at the magnified image too long. It may cause eyestrain or make you feel sick.

Magnification mirror For Sales Promotion Items



The double-layered lid of CRYSTAL COMPACT MIRROR can be decorated by inserting various cards or printed pieces with your idea.

Compact Mirrors with Double-Layered Lids, Round and Square Forms
CRYSTAL COMPACT MIRROR with Double-layered Lid

Product name	Item Code.	Size	Color	Material
CRYSTAL COMPACT MIRROR, round, with Double-layered Lid	CR-02	85mm×8.7mm	clear	[Frame]PS resin, acrylate resin [Mirror]glass mirror
CRYSTAL COMPACT MIRROR, square, with Double-layered Lid	CR-04	81mm×81mm	clear	[Frame]PS resin, acrylate resin [Mirror]glass mirror

For Sales Promotion Items

Combination of plain and magnification mirrors!
 Compact and Cute double-sided mirror.

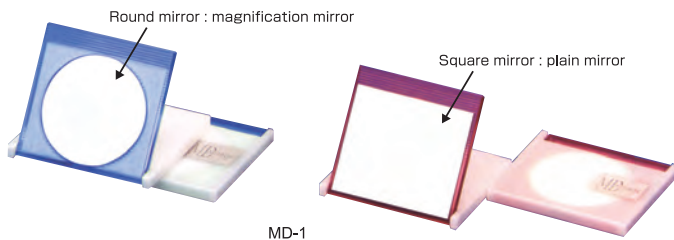

Double-sided Mirror with Plain and Magnification Mirrors
2-WAY MIRROR

Product name	2-WAY MIRROR
Item Code.	MD-1
Suggested retail price	¥500 and tax
Size	80mm×71mm
Color	Red / BLUE
Quantity per carton	240
Material	[Frame]PS resin [Mirror]Napure mirror

Magnification mirror For Sales Promotion Items

[Precaution for use]*The magnification mirrors may focus the sun's rays to burn up a combustible material and cause fire. So do not use or store the magnification mirrors under direct sunlight.*At first, move your face close to the magnification mirror and then move away from the mirror to find the focal point you can see clearly reflected image.*Do not look at the magnified image too long. It may cause eyestrain or make you feel sick.

*Round mirror : 57-mm-diameter magnification mirror.
 Square mirror : 67 mm x 57 mm plain mirror.
 *The 2x magnification mirror is made of a concave mirror having the radius of curvature (R) of 1000.

From Compact to Stand Mirrors

Various Forms and Sizes for Sales Promotion Items

With Corporate or Product Logo!

For Sales Promotion Items

Easy Facial Massage with the Mirror, **MESSAGE MIRROR**

The direction for facial and skin massage is printed on the front of the double-sided stand mirror. You can easily master the basic skill of the massage rightly with the mirror, and check the effect in the plain mirror on the back after the massage.



MESSAGE MIRROR for Facial Massage & MESSAGE MIRROR for Facial Acupressure Point **MESSAGE MIRROR**

Product name	Item Code.	Size	Color	Quantity per carton	Material
MESSAGE MIRROR for Facial Massage	EM-01	200mm×220mm	Silver	36	[Frame]aluminum [Mirror]glass mirror
MESSAGE MIRROR for Facial Acupressure Point	EM-02	200mm×220mm	Silver	36	[Frame]aluminum [Mirror]glass mirror

Slant adjustable For Sales Promotion Items

*The mirrors are made to order. We will welcome your contact.

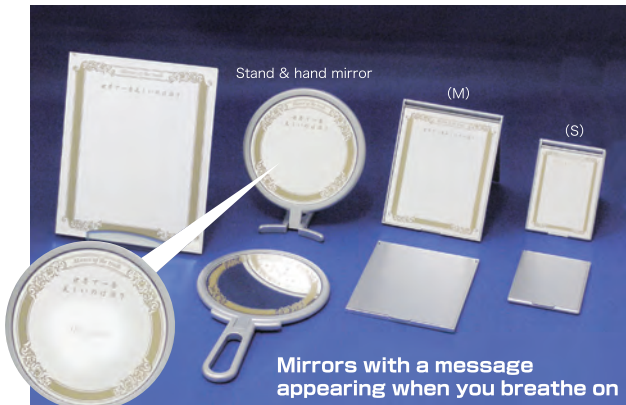

Mirrors showing a message when blown by your breath **MESSAGE MIRROR**

Product name	MAGICAL MESSAGE MIRROR
Size	The price is estimated according to the size and frame materials of the mirror and the amount to be ordered. <Examples of the sizes of the mirrors> Compact mirror (S): 70 mm x 95 mm Compact mirror (L): 104 mm x 130 mm Stand& hand mirror: 127 mm x 215 mm

For Sales Promotion Items

Examples of the Professional Model Foldable Stand Mirrors



The fabric for the frame can be selected from the samples we provide.

Examples of the UV-Indication Mirrors



The mirrors of unique design can be created by decorating with logos and illustrations.

From Compact to Stand Mirrors

Various Forms and Sizes for Sales Promotion Items

With Corporate or Product Logo!

...Examples of Pub Mirrors...



Material: Wooden frame, glass mirror
Size: 520mm×770mm



Material: Aluminum frame, glass mirror
Size: 320mm×420mm



Material: Wooden frame, glass mirror
Size: 300mm×170mm



Commemorative of the championship of Giants led by Mr. Nagashima

Material: Plastic frame, glass mirror
Size: 300mm×450mm



Commemorative of the Japanese national soccer team

Material: Plastic frame, glass mirror
Size: 300mm×450mm



Character items

Material: Plastic frame, glass mirror
Size: 250mm×450mm



Photo-Display Pub Mirror
(The photos can be replaced.)

Material: Plastic stand, glass mirror
Size: 150mm×180mm

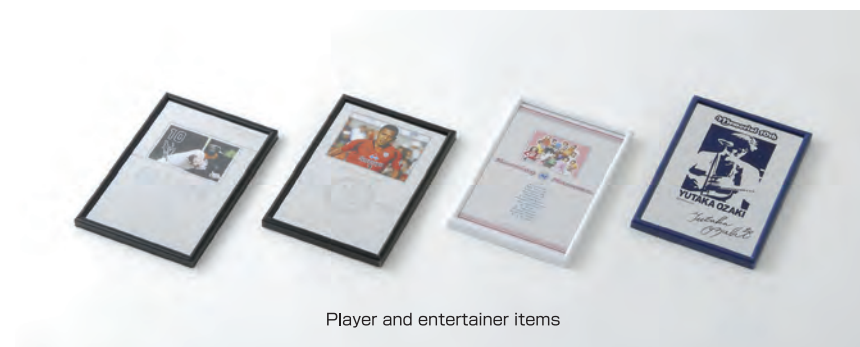

Player and entertainer items

Material: Plastic frame, glass mirror
Size: 120mm×180mm

For unique sales promotion items with the logos of your shop and products!
Good for the gifts commemorating games and competitions!

*The price of a pub mirror is estimated according to the size, coloration and frame materials of the mirror and the amount to be ordered.

*Do not give impact to the mirrors by dropping off, etc. Impacted mirrors may break and hurt the user. The metal parts of the mirrors are deteriorated when stored at high temperature and humidity for a long time. Chemicals sticking on the mirrors must be wiped off with dry cloth.

HORIUCHI MIRROR INDUSTRY CO., LTD.

1-5-11 Nishiwaki, Hirano-Ku, Osaka-Shi, Osaka 547-0035, Japan TEL : +81-6-6702-1987 / FAX : +81-6-6702-5003

[e-mail horouchi@cr-horiuchi.co.jp](mailto:horouchi@cr-horiuchi.co.jp) [HP http://www.cr-horiuchi.co.jp](http://www.cr-horiuchi.co.jp)

Revised in November, 2022