

NEW

"Napure Mirror" PROFESSIONAL MODEL FOLDABLE STAND MIRROR PREMIUM

New Professional Model Foldable Stand Mirror with height changeable for makeup situation

Patented Foldable Stand Mirror

PAT.5764853

Patented Mirror **napure** MIRROR

"Napure Mirror" is a high-class mirror more excellent than others and reflects the real color of your skin as seen by others.

Japanese Patent No.3732490



Can be folded into a compact-sized mirror

Don't you use your stand mirror in this way?

A tissue box or book lifts the mirror used on a low table.

If you turn back the whole and fold the base of the mirror upward,

the mirror surface is raised by 85 mm to provide convenience in makeup.

Two forms for easy makeup

The mirror is raised by the folded base to be set right in front of your face. **Tall form**

The adjustable slant improves convenience in use.

Slant adjustable into four levels for convenience in makeup

Slant adjustable into four levels **Normal form**

How to set the normal form

- 1 Raise the mirror and fix the end of the mirror on one of the grooves A, B, C and D to slant the mirror to a level you like.

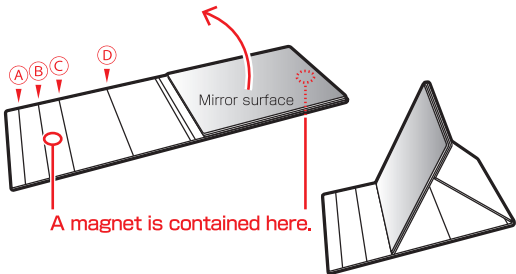

The normal form has been set.

How to set the tall form

- 1 Reverse the whole, raise the mirror and fold the base at the groove D.
- 2 Attach the end of the mirror onto the part F. The magnet contained in the part F fix the end of the mirror.

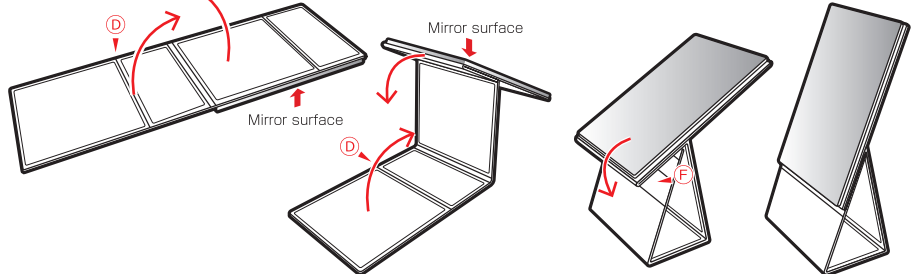

The tall form has been set.

What is "Napure Mirror"?

The mirror reflecting the real color of your skin as seen by others

The most suitable mirror for matching the colors of your skin and foundation and for partial makeup

Glass of high clarity + Reflective metal layer by vacuum deposition = "Napure Mirror" reflects natural pure colors with minimum change.

Glass of high clarity

The glass used for the conventional mirrors contains considerable amount of iron to absorb blue light of the incident light and make white color look dull. We have developed "Napure Mirror" made of clear glass with minimum iron content. "Napure Mirror" rarely changes the reflected colors to show natural and pure colors without influence by the glass. Thus "Napure Mirror" is the most suitable for matching the foundation to the colors of your skin and partial makeup.

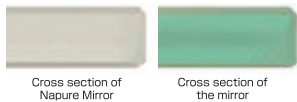

Napure Mirror (in our test)

Reflects real color of human skin with minimum color change.



Conventional silver glass mirror (in our test)

White color is reflected into slightly yellowish white and other colors are reflected colors look dull.

Comparison in reflection (in our test)

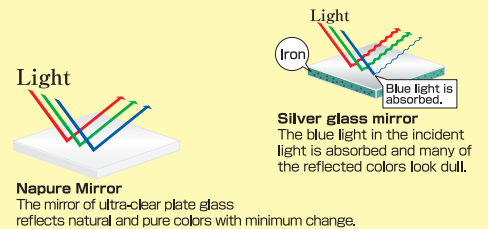

Napure Mirror
The mirror of ultra-clear plate glass reflects natural and pure colors with minimum change.

*The photo shows an image of reflection.

"Napure Mirror" PROFESSIONAL MODEL FOLDABLE STAND MIRROR PREMIUM (XL)

*Each of the "JAN codes" given in six digits in this catalogue constitutes the product code and check digit, and follows the code, 4510510 indicating the country and manufacturer codes.

Product name	Item Code	Suggested retail price	Size	Color			Material
				Coral	JAN	Quantity per carton	
"Napure Mirror" PROFESSIONAL MODEL FOLDABLE STAND MIRROR PREMIUM (XL)	HP-90	¥4,400 and tax	[Product] 185mm×280mm×12mm (when folded) 185mm×280mm×260mm (Normal form) / 185mm×115mm×335mm (Tall form) [Mirror size] 180mm×260mm [Package] 200mm×290mm×25mm [Carton size] 555mm×317mm×245mm [Net weight] approx. 560 g, Gross weight: approx. 655 g in the package / approx. 15 kg in the carton	Black	773951	20	[Frame] EVA resin, magnet [Mirror] Napure Mirror

[Cautions for the product containing a magnet] ● Persons with implanted medical electronics, such as cardiac pacemakers, must not use the product. ● Do not swallow the magnet in the product that may cause fatal damage. The magnet swallowed and kept in the digestive organ may require abdominal surgery. If you swallow the magnet, immediately consult a physician and follow his/her direction. ● Keep the product beyond the reach of infants, children and persons requiring supervision in order to keep them from swallowing the magnet in the product. ● The magnet in the product or the surface treatment of the magnet may crack or peel by the shock when the magnet vigorously attract another magnet or metal body. ● Two magnets attracting to each other may hardly be separated depending on their shapes. ● Do not leave the magnet carelessly. The magnet may vigorously attract another magnet or metal bodies nearby to cause danger. ● Keep the magnet away from mobile phones, analogue quartz clocks and watches, magnetic cards and magnetic tapes in order to prevent malfunction or damage on memory.

[Handling precautions] *The product may be damaged by excessive stress or shock. *Do not place the product on a wobbly table or drop down the product. *Do not expose the product to high temperature by leaving at a place near fire, heat source, etc. High temperature may make the product cause fire or may deform or discolor the product. Do not expose the product to direct sunlight for a long time. *Keep the product beyond the reach of infants and children. *Wipe the stain on the product and mirror lightly with soft cloth. Do not clean the product with a cleanser, paint thinner, benzene or alcohol. *The glass mirror may injure the user when it is cracked. *Do not wet the product with water or leave it at a humid place. The product is degraded by moisture.



HORIUCHI MIRROR INDUSTRY CO., LTD. e-mail horiuchi@cr-horiuchi.co.jp HP http://www.cr-horiuchi.co.jp
1-5-11 Nishiwaki, Hirano-Ku, Osaka-Shi, Osaka 547-0035, Japan TEL : +81-6-6702-1987 / FAX : +81-6-6702-5003